

- GENERAL NOTES:**
1. DRAWINGS NOT TO BE USED FOR CONSTRUCTION UNLESS AUTHORIZED BY THE LANDSCAPE ARCHITECT.
  2. CONTRACTOR SHALL REPORT ANY DISCREPANCIES BETWEEN THE DRAWINGS AND SITE CONDITIONS PRIOR TO COMMENCEMENT OF THE WORK.
  3. ALL UTILITY LOCATIONS ARE THE RESPONSIBILITY OF THE CONTRACTOR. HANDS OFF WITHIN THE LIMITS RECOMMENDED BY THE SERVICE UTILITY. UTILITY CONFLICTS WITH PROPOSED TREE LOCATIONS MUST BE REPORTED IMMEDIATELY TO THE LANDSCAPE ARCHITECT.
  4. BASE DRAWINGS PROVIDED BY DIAMOND SCHMITT ARCHITECTS.
  5. VEGETATION INVENTORY BY GSP GROUP INC.
  6. LANDSCAPE DRAWINGS SHOW ENGINEERING INFORMATION FOR DESIGN PURPOSES ONLY. DO NOT CONSTRUCT ENGINEERING WORKS FROM THESE DRAWINGS.

- LEGEND**
- EXISTING TREE TO REMAIN
  - EXISTING TREE TO BE REMOVED
  - TREE PROTECTION FENCING
  - EXISTING PLANTING MATERIAL TO BE REMOVED
  - EXISTING PAVING MATERIAL TO BE REMOVED
  - SCOPE OF WORK
  - PROPERTY BOUNDARY

- DEMOLITION NOTE:**
1. FOR TREE REMOVAL, PRESERVATION AND TREE PROTECTION FENCING LOCATIONS, REFER TO DRAWING L001.

**ISSUED**

NO.	DATE	DESCRIPTION
1	2024-05-16	Issued for Early Works Draft
2	2024-07-10	Issued for Coordination
3	2024-07-11	Issued for Owner Review
4	2024-09-19	Issued for Site Plan Approval
5	2024-11-28	Issued for Site Plan Approval

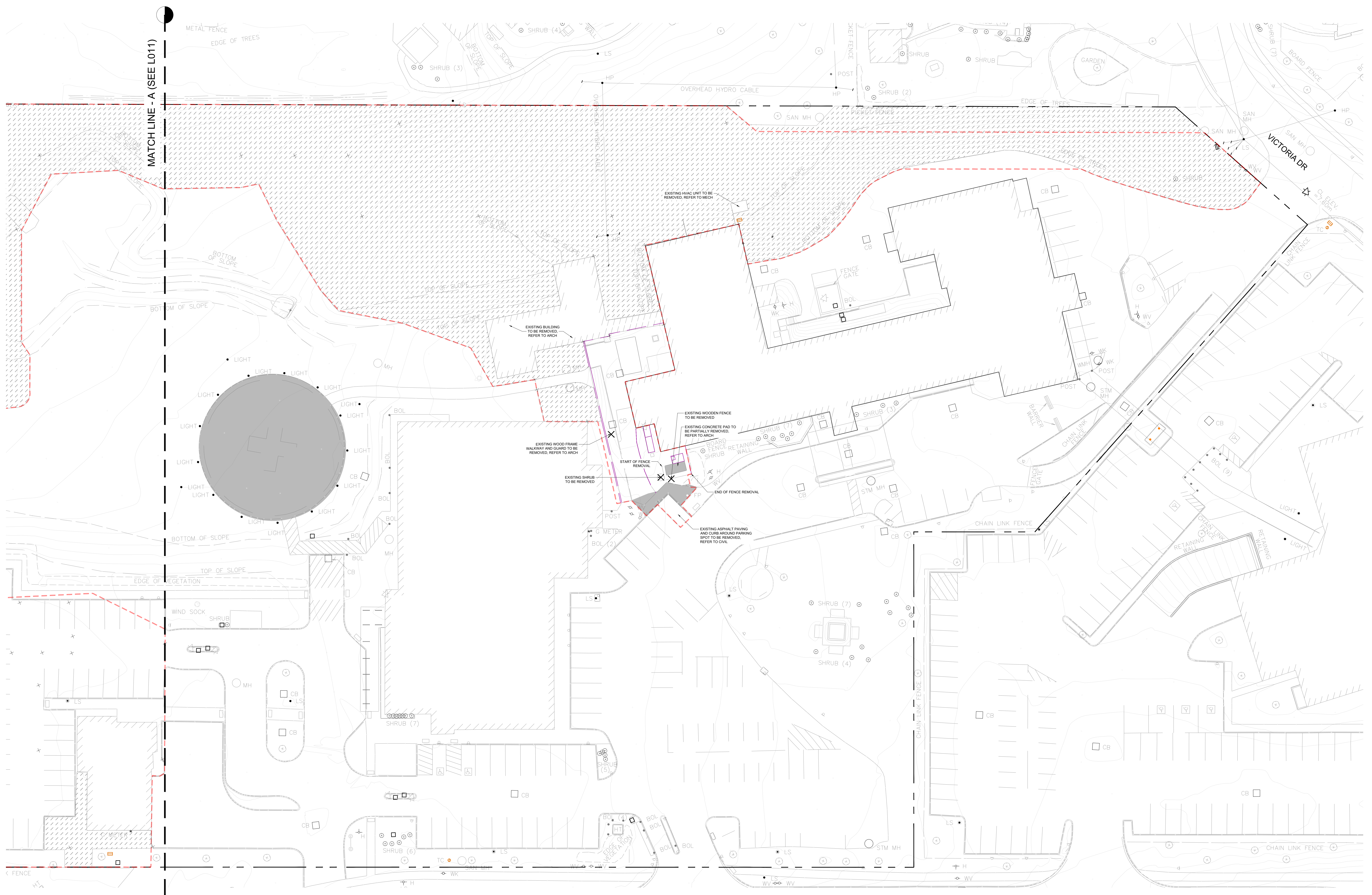

NOT FOR CONSTRUCTION

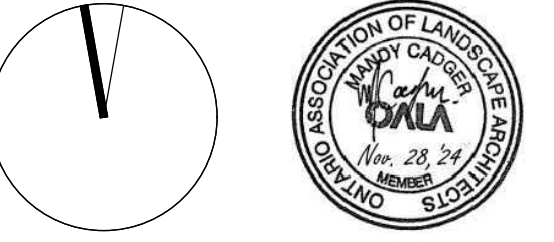

CONTRACTOR MUST CHECK & VERIFY ALL DIMENSIONS ON THE JOB.

DO NOT SCALE DRAWINGS.

ALL DRAWINGS, SPECIFICATIONS AND RELATED DOCUMENTS ARE THE COPYRIGHT PROPERTY OF THE ARCHITECT. ANY REUSE OR REPRODUCTION WITHOUT WRITTEN PERMISSION OF THE ARCHITECT IS STRICTLY PROHIBITED.

THIS DRAWING IS NOT TO BE USED FOR CONSTRUCTION UNITS, SIGNED BY THE ARCHITECT.



Uxbridge Hospital  
PROJECT NO: 23175



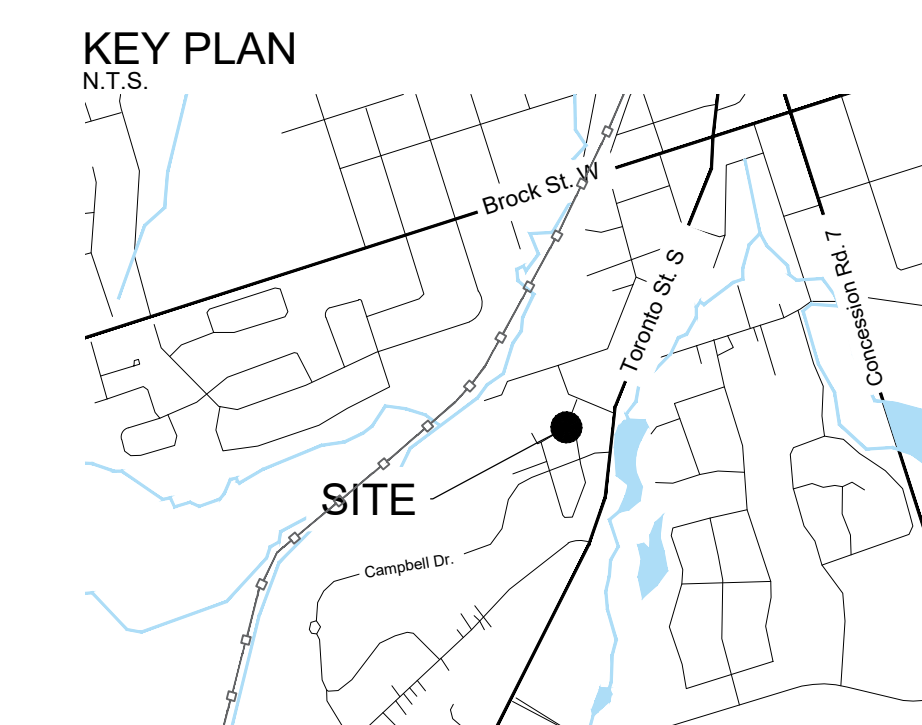

- GENERAL NOTES:**
1. DRAWINGS NOT TO BE USED FOR CONSTRUCTION UNLESS AUTHORIZED BY THE LANDSCAPE ARCHITECT
  2. CONTRACTOR SHALL REPORT ANY DISCREPANCIES BETWEEN THE DRAWINGS AND SITE CONDITIONS PRIOR TO COMMENCEMENT OF THE WORK
  3. ALL UTILITY LOCATES ARE THE RESPONSIBILITY OF THE CONTRACTOR. HANDS OFF WITHIN THE LIMITS RECOMMENDED BY THE SERVICE UTILITY. UTILITY CONFLICTS WITH PROPOSED TREE LOCATIONS MUST BE REPORTED IMMEDIATELY TO THE LANDSCAPE ARCHITECT
  4. BASE DRAWINGS PROVIDED BY DIAMOND SCHMITT ARCHITECTS
  5. VEGETATION INVENTORY BY GSP GROUP INC.
  6. LANDSCAPE DRAWINGS SHOW ENGINEERING INFORMATION FOR DESIGN PURPOSES ONLY. DO NOT CONSTRUCT ENGINEERING WORKS FROM THESE DRAWINGS.

**LEGEND**

- EXISTING TREE TO REMAIN
- ⊗ EXISTING TREE TO BE REMOVED
- TREE PROTECTION FENCING
- ▨ EXISTING PLANTING MATERIAL TO BE REMOVED
- ▨ EXISTING PAVING MATERIAL TO BE REMOVED
- SCOPE OF WORK
- PROPERTY BOUNDARY

**DEMOLITION NOTE:**

1. FOR TREE REMOVAL, PRESERVATION AND TREE PROTECTION FENCING LOCATIONS, REFER TO DRAWING L001.

**ISSUED**

NO.	DATE	DESCRIPTION
1	2024-05-16	Issued for Early Works Draft
2	2024-07-10	Issued for Coordination
3	2024-07-11	Issued for Owner Review
4	2024-09-19	Issued for Site Plan Approval
5	2024-11-28	Issued for Site Plan Approval



NOT FOR CONSTRUCTION

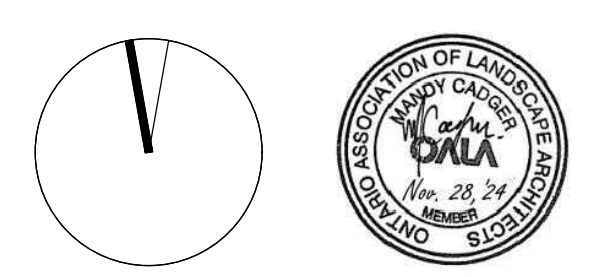

CONTRACTOR MUST CHECK & VERIFY ALL DIMENSIONS ON THE JOB  
DO NOT SCALE DRAWINGS.  
ALL DRAWINGS, SPECIFICATIONS AND RELATED DOCUMENTS ARE THE COPYRIGHT PROPERTY OF THE ARCHITECT. THESE DOCUMENTS ARE TO BE USED ONLY FOR THE REPRODUCTION OF DRAWINGS, SPECIFICATIONS AND RELATED DOCUMENTS IN PART OR WHOLE OR OTHERWISE WITHOUT THE WRITTEN PERMISSION OF THE ARCHITECT.  
THIS DRAWING IS NOT TO BE USED FOR CONSTRUCTION UNLESS SIGNED BY THE ARCHITECT.



Uxbridge Hospital  
PROJECT NO: 23175

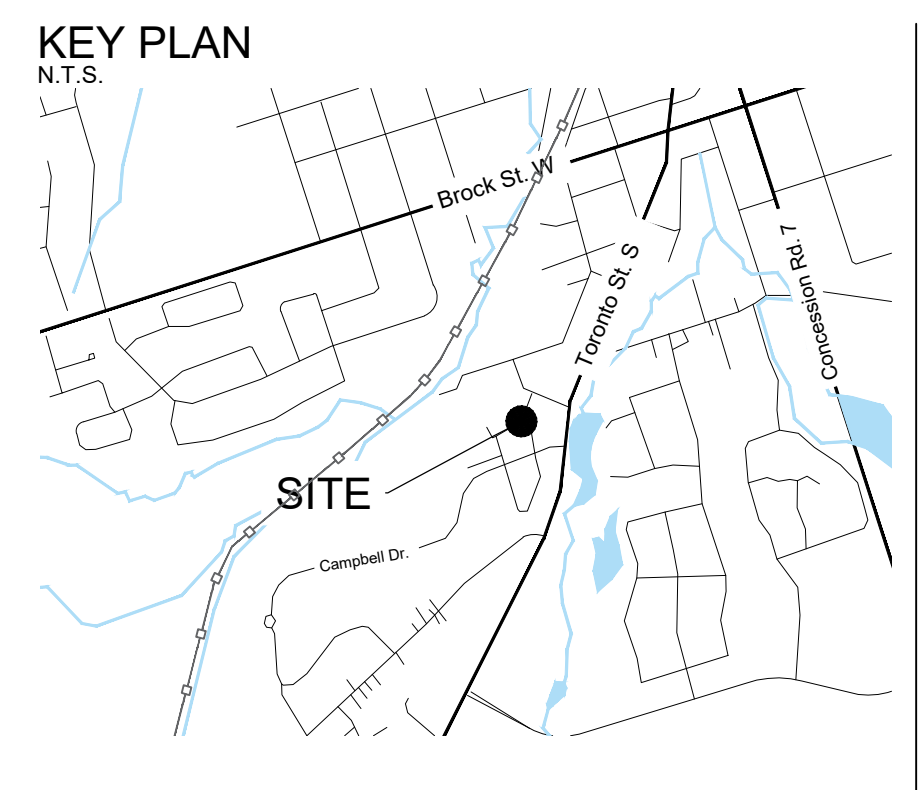

- GENERAL NOTES:**
- DRAWINGS NOT TO BE USED FOR CONSTRUCTION UNLESS AUTHORIZED BY THE LANDSCAPE ARCHITECT.
  - CONTRACTOR SHALL REPORT ANY DISCREPANCIES BETWEEN THE DRAWINGS AND SITE CONDITIONS PRIOR TO COMMENCEMENT OF THE WORK.
  - ALL UTILITY LOCATES ARE THE RESPONSIBILITY OF THE CONTRACTOR. HANDS WITHIN THE LIMITS RECOMMENDED BY THE SERVICE UTILITY. UTILITY CONFLICTS WITH PROPOSED TREE LOCATIONS MUST BE REPORTED IMMEDIATELY TO THE LANDSCAPE ARCHITECT.
  - BASE DRAWINGS PROVIDED BY DIAMOND SCHMITT ARCHITECTS.
  - VEGETATION INVENTORY BY GSP GROUP INC.
  - LANDSCAPE DRAWINGS SHOW ENGINEERING INFORMATION FOR DESIGN PURPOSES ONLY. DO NOT CONSTRUCT ENGINEERING WORKS FROM THESE DRAWINGS.

**LEGEND**

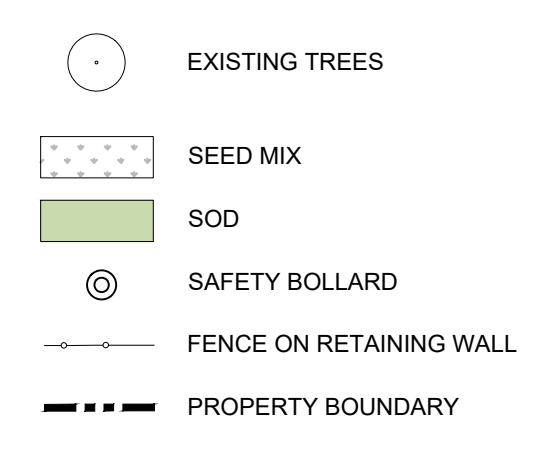

**NOTE:**

- CONTRACTOR TO INSTALL TEMPORARY GUARD ALONG RETAINING WALL WHERE GRADE CHANGE EXCEEDS 0.6m. GUARD TO BE FAST FENCE SECURED INTO THE GROUND WITH 15mm AND SECURED TOGETHER WITH SERIES OF ZIP TIES. TEMPORARY GUARD TO BE MAINTAINED THROUGH CONSTRUCTION UNTIL INSTALLATION OF FINAL PHASE.
- REPAIR DAMAGED SURFACE CONDITIONS TO EXISTING GRADES AS NECESSARY. CONSULT THE LANDSCAPE ARCHITECT PRIOR TO EXECUTING WORK.

**ISSUED**

NO.	DATE	DESCRIPTION
1	2024-05-16	Issued for Early Works Draft
2	2024-07-10	Issued for Coordination
3	2024-07-11	Issued for Owner Review
4	2024-09-19	Issued for Site Plan Approval
5	2024-11-28	Issued for Site Plan Approval

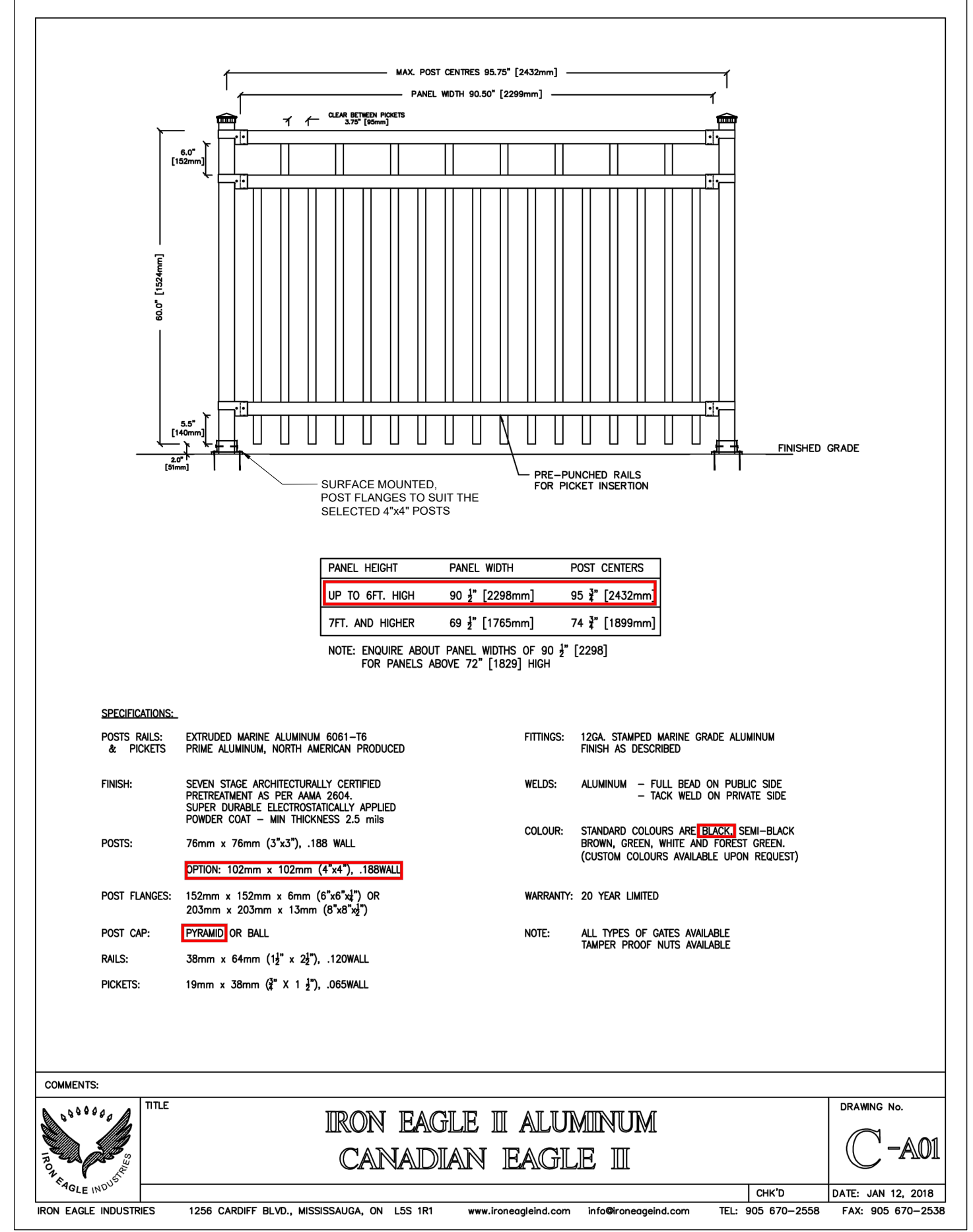

**4 ALUMINUM FENCE ON RETAINING WALL NTS**

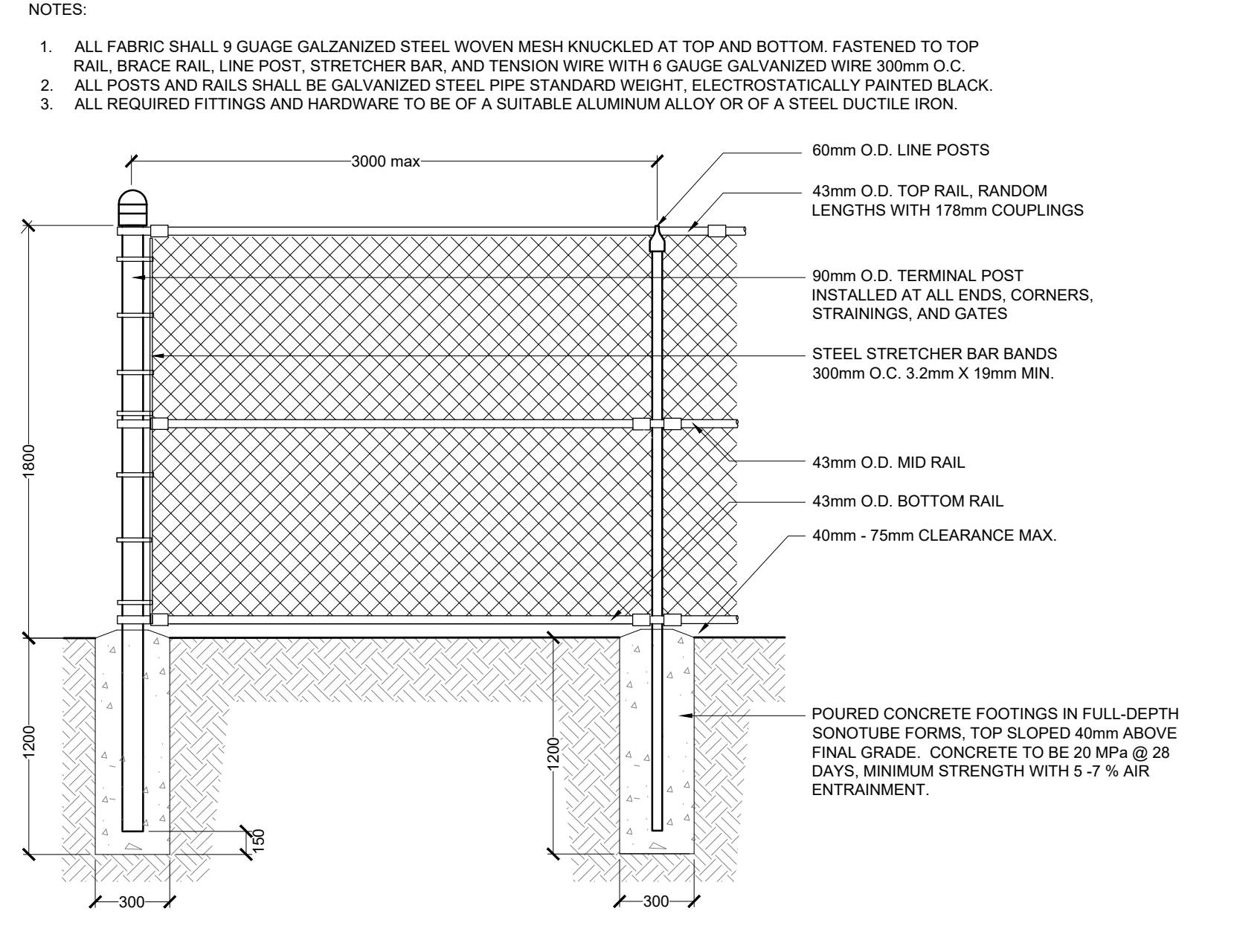

**3 1.8M CHAIN LINK FENCE 1:10**

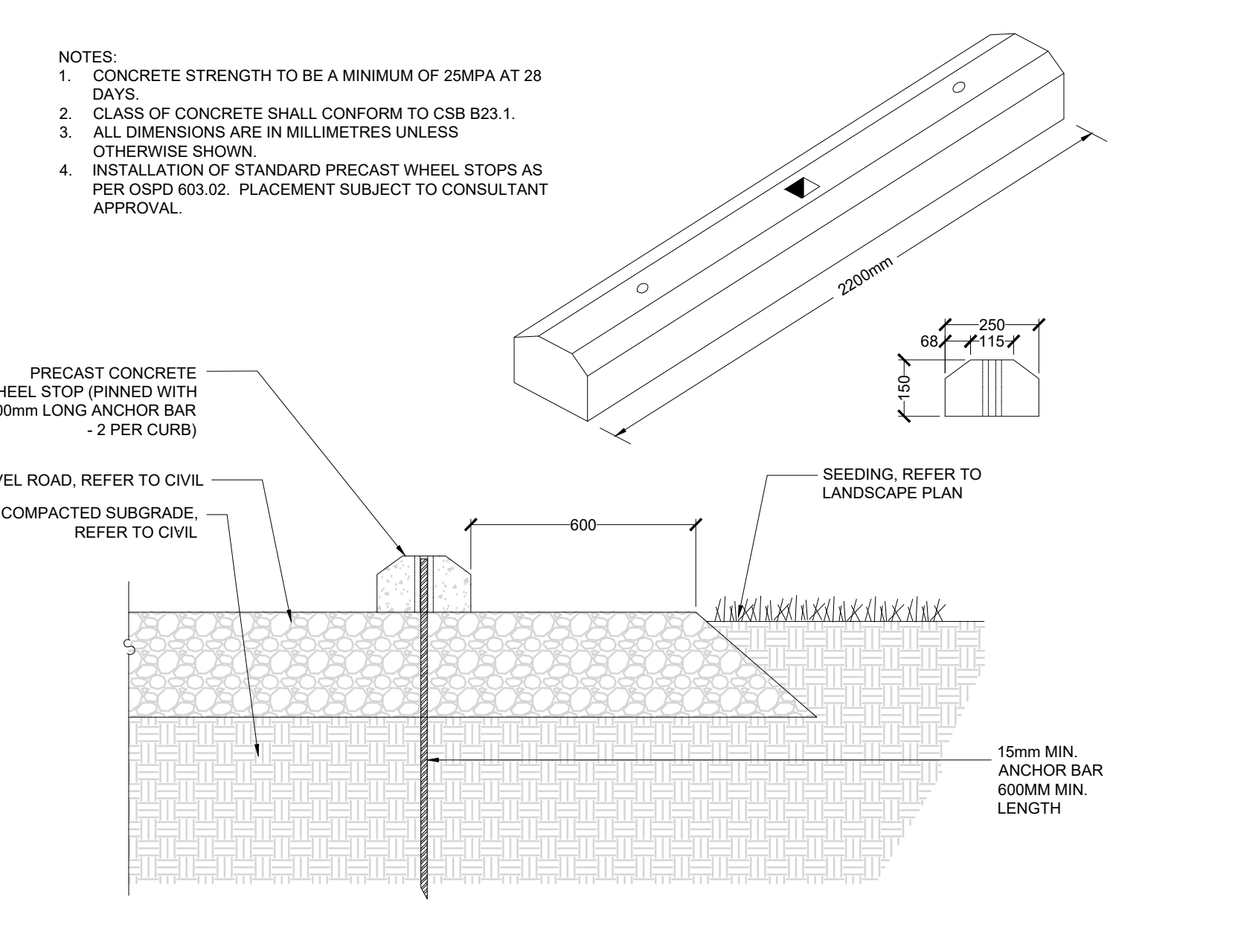

**2 PRE-CAST BUMPER CURB 1:10**

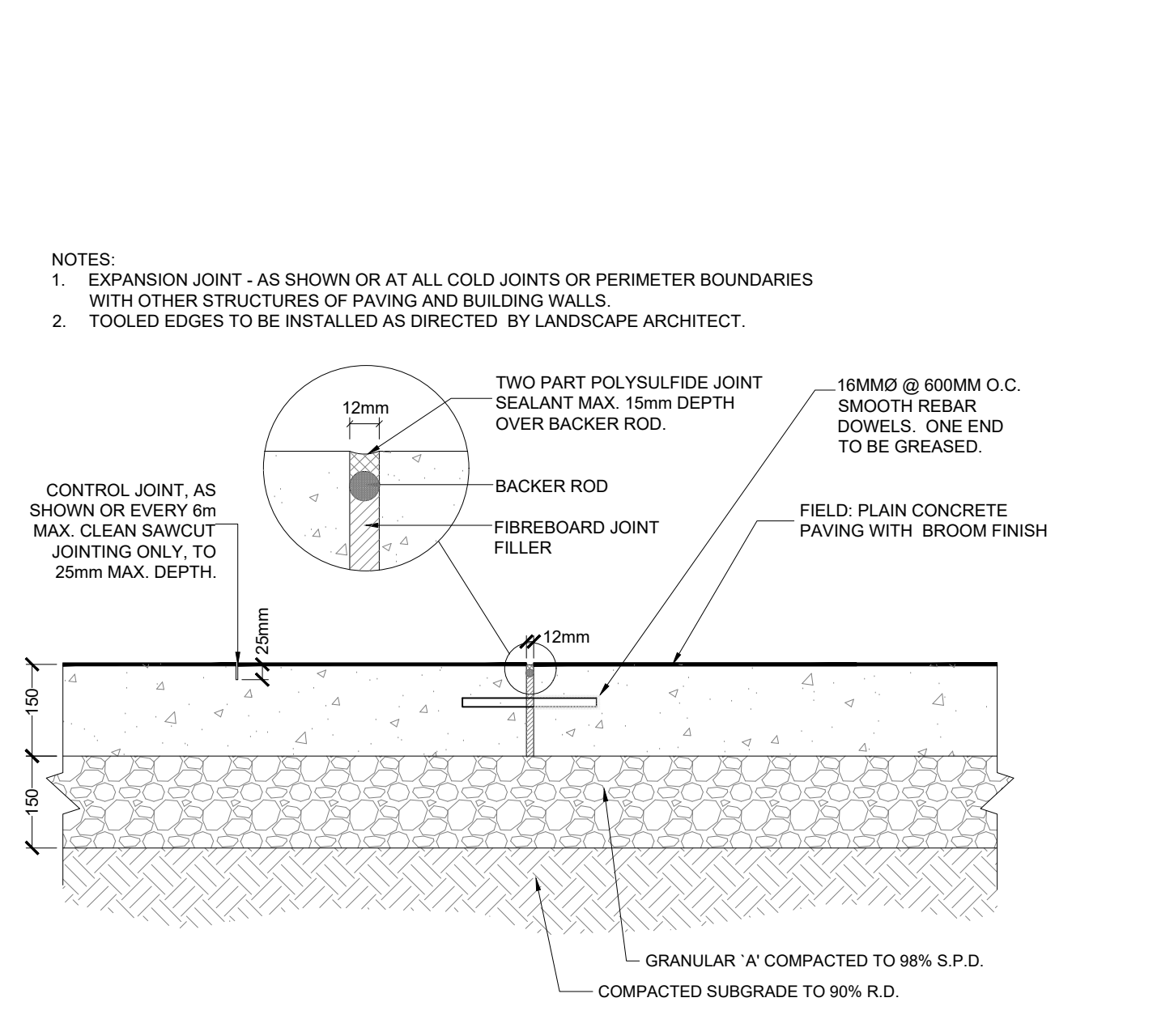

**1 CONCRETE PAVING 1:10**

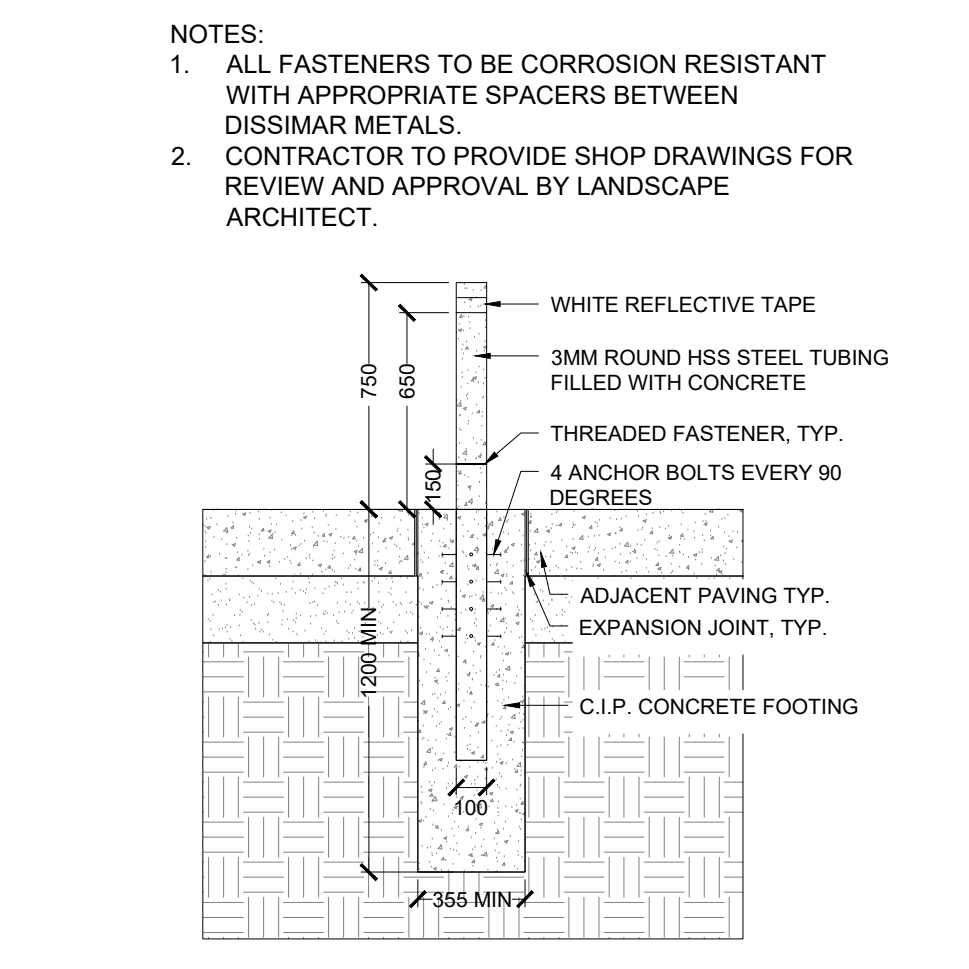

**3 SAFETY BOLLARD 1:10**

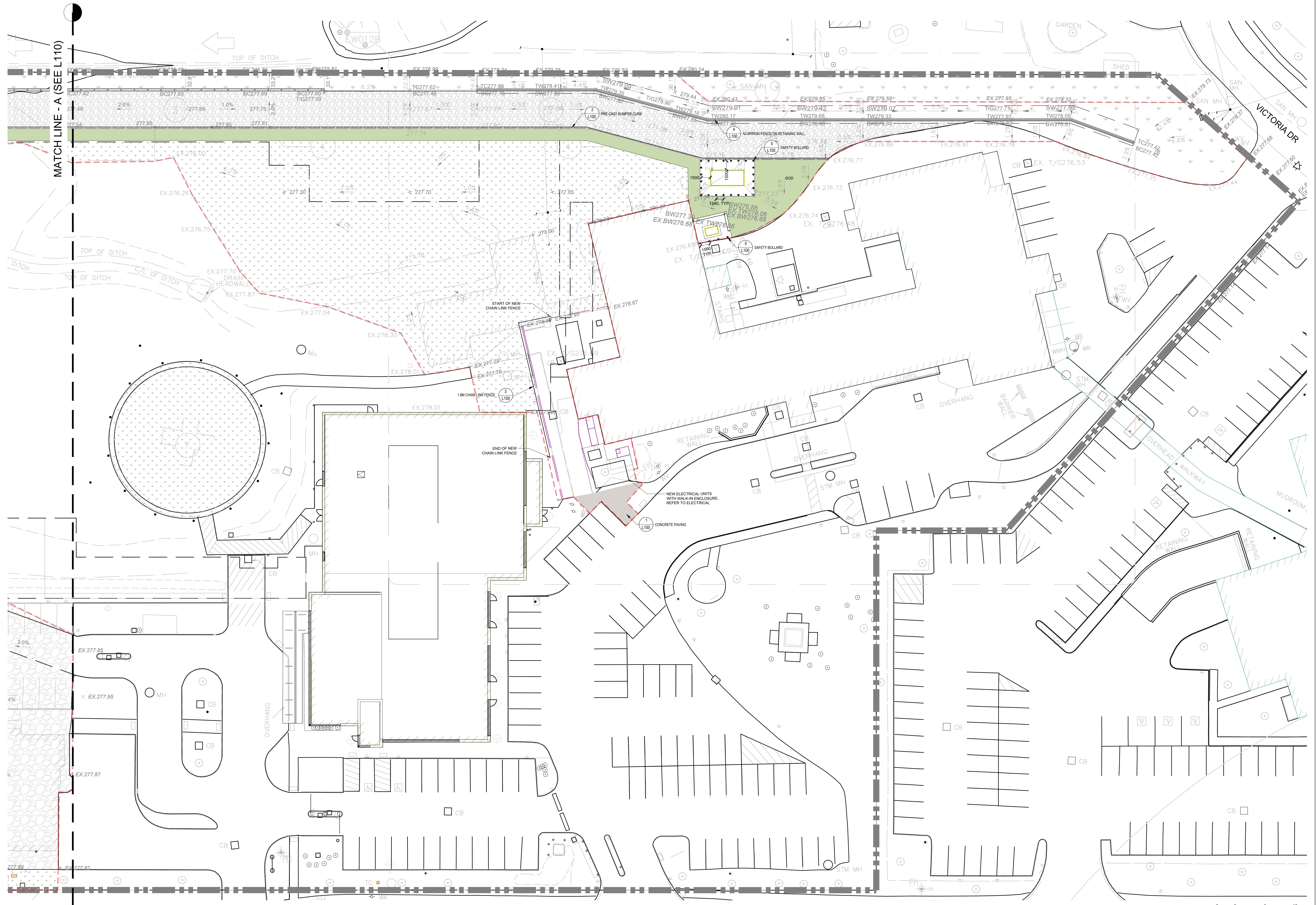

**NO-MOW MEADOW "A" SEED MIXTURE**  
 50% AT 25KG/ HA + NURSE CROP

1%	Anemone canadensis	Canada Anemone
2%	Asclepias syriaca	Common Milkweed
15%	Carex granularis	Limestone Meadow Sedge
40%	Elymus virginicus	Virginia Wildrye
1%	Euthamia graminifolia	Grass-leaved Goldenrod
1%	Monarda fistulosa	Wild Bergamot
25%	Oenothera biennis	Common Evening Primrose
10%	Rudbeckia hirta	Black Eyed Susan
1%	Solidago canadensis	Canada Goldenrod
1%	Solidago juncea	Early Goldenrod
1%	Solidago nemoralis	Gray-stemmed Goldenrod
1%	Symphoricarum novae-angliae	New England Aster
1%	Verbena urticifolia	White Vervain

- SEEDING NOTES**
- SEEDING SHALL BE PERFORMED BETWEEN MID-MAY AND MID-SEPTEMBER. OBTAIN CONSULTANT'S APPROVAL FOR ANY SEEDING OUTSIDE OF THE ABOVE REFERRED WINDOW.
  - APPLY HYDRALIC MIXTURE EVENLY AND UNIFORMLY AND AT SUCH A RATE TO MEET THE COVERAGE SPECIFIED IN OPSIS 572.
  - STRAW SHOULD JUST COVER THE SOIL SURFACE, BUT NOT BURRY IT. SOME SOIL SHOULD BE VISIBLE THROUGH THE STRAW - TO A MINIMUM OF 10%.
  - ALL SEEDING TO BE APPLIED THROUGH HYDRALIC METHOD EXCEPT AREAS WHERE CONDITIONS WILL ONLY PERMIT MECHANICAL SEEDING. CONTRACTOR TO OBTAIN CONSULTANT'S APPROVAL FOR ALL ALTERNATE SEEDING METHODS.
  - FOR AREAS WHERE SEED IS APPLIED TO STEEP SLOPES (1:1 AND ABOVE) AN EROSION CONTROL BLANKET SHALL BE APPLIED AND STAKED APPROPRIATELY.

**NOTE:**  
 1. ALL SEEDING AREAS SHALL HAVE MINIMUM TOPSOIL DEPTH OF 150mm.

CONTRACTOR MUST CHECK & VERIFY ALL DIMENSIONS ON THE JOB.  
 DO NOT SCALE DRAWINGS.  
 ALL DRAWINGS, SPECIFICATIONS AND RELATED DOCUMENTS ARE THE COPYRIGHT PROPERTY OF DIAMOND SCHMITT AND MUST BE KEPT UNDER LOCK AND KEY. UNAUTHORIZED REPRODUCTION OF DRAWINGS, SPECIFICATIONS AND RELATED DOCUMENTS IN ANY PART OR WHOLE IS FORBIDDEN WITHOUT THE WRITTEN PERMISSION OF THE ARCHITECT.



Uxbridge Hospital  
 PROJECT NO.: 23175

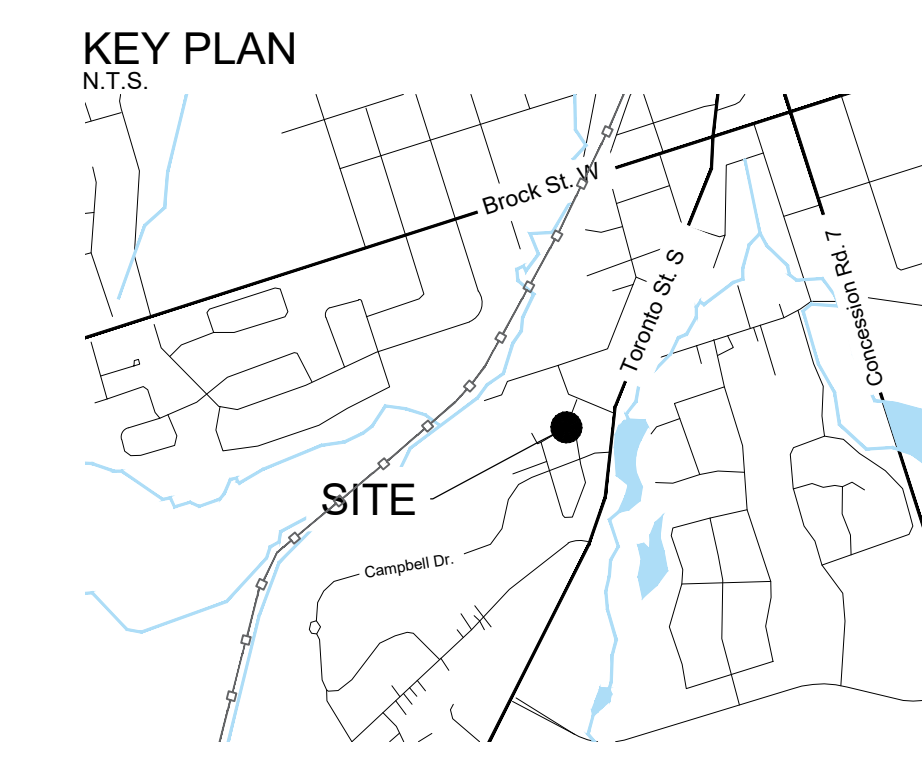

- GENERAL NOTES:**
1. DRAWINGS NOT TO BE USED FOR CONSTRUCTION UNLESS AUTHORIZED BY THE LANDSCAPE ARCHITECT
  2. CONTRACTOR SHALL REPORT ANY DISCREPANCIES BETWEEN THE DRAWINGS AND SITE CONDITIONS PRIOR TO COMMENCEMENT OF THE WORK
  3. ALL UTILITY LOCATES ARE THE RESPONSIBILITY OF THE CONTRACTOR. HANDS OFF WITHIN THE LIMITS RECOMMENDED BY THE SERVICE UTILITY. UTILITY CONFLICTS WITH PROPOSED TREE LOCATIONS MUST BE REPORTED IMMEDIATELY TO THE LANDSCAPE ARCHITECT
  4. BASE DRAWINGS PROVIDED BY DIAMOND SCHMITT ARCHITECTS
  5. VEGETATION INVENTORY BY GSP GROUP INC.
  6. LANDSCAPE DRAWINGS SHOW ENGINEERING INFORMATION FOR DESIGN PURPOSES ONLY. DO NOT CONSTRUCT ENGINEERING WORKS FROM THESE DRAWINGS.

- LEGEND**
- EXISTING TREES
  - SEED MIX
  - SOD
  - SAFETY BOLLARD
  - FENCE ON RETAINING WALL
  - PROPERTY BOUNDARY

**ISSUED**

NO.	DATE	DESCRIPTION
1	2024-05-16	Issued for Early Works Draft
2	2024-07-10	Issued for Coordination
3	2024-07-11	Issued for Owner Review
4	2024-09-19	Issued for Site Plan Approval
5	2024-11-28	Issued for Site Plan Approval

**NOTE:**

1. CONTRACTOR TO INSTALL TEMPORARY GUARD ALONG RETAINING WALL WHERE GRADE CHANGE EXCEEDS 0.6m. GUARD TO BE FAST FENCE SECURED INTO THE GROUND WITH 1 BARS AND SECURED TOGETHER WITH SERIES OF 2P TIES. TEMPORARY GUARD TO BE MAINTAINED THROUGH CONSTRUCTION UNTIL INSTALLATION OF FINAL PHASE. REPAIR DAMAGED SURFACE CONDITIONS TO EXISTING GRADES AS NECESSARY. CONSULT THE LANDSCAPE ARCHITECT PRIOR TO EXECUTING WORK.

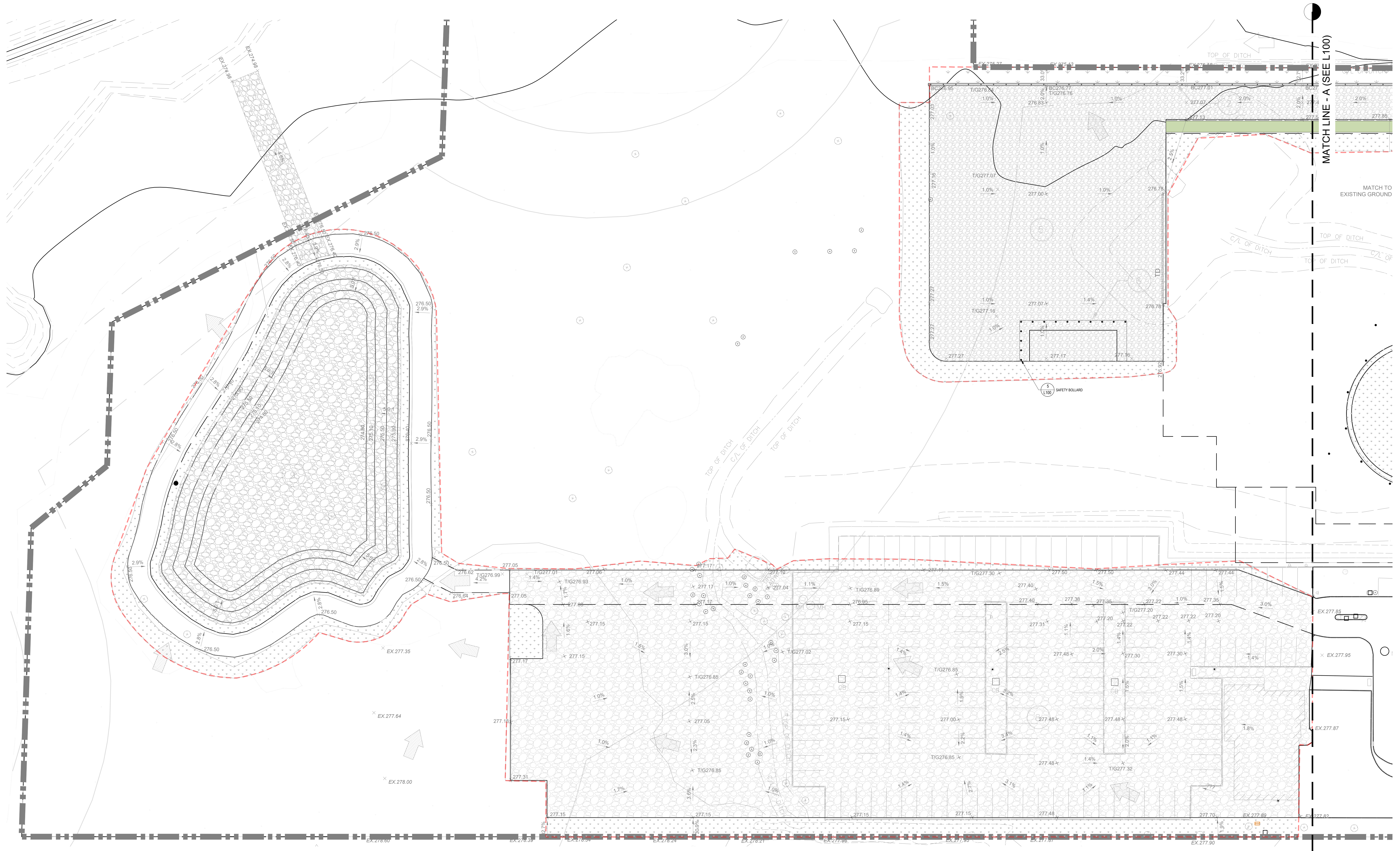

NOT FOR CONSTRUCTION

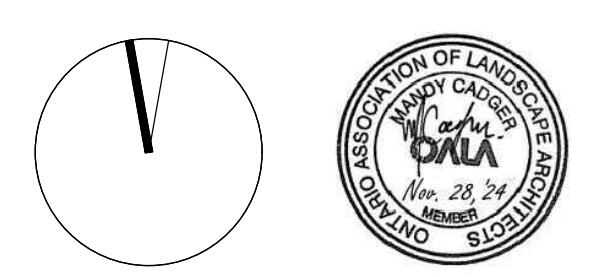

CONTRACTOR MUST CHECK & VERIFY ALL DIMENSIONS ON THE JOB  
DO NOT SCALE DRAWINGS.  
ALL DRAWINGS, SPECIFICATIONS AND RELATED DOCUMENTS ARE THE COPYRIGHT PROPERTY OF THE ARCHITECT AND MUST BE USED ONLY FOR THE PROJECT REPRODUCED IN PART OR IN WHOLE OR FOR OTHER PROJECTS WITHOUT THE WRITTEN PERMISSION OF THE ARCHITECT.  
THIS DRAWING IS NOT TO BE USED FOR CONSTRUCTION UNTIL SIGNED BY THE ARCHITECT.



Uxbridge Hospital  
PROJECT NO: 23175

