

AIR SIDE SYSTEM ABBREVIATIONS

L/S	LITER PER SECOND
E/A	EXHAUST AIR
O/A	OUTSIDE AIR
R/A	RETURN AIR
S/A	SUPPLY AIR

PIPING LEGEND

	SINGLE LINE PIPE RISE
	SINGLE LINE PIPE DROP
	PIPE TEE OFF THE TOP
	PIPE TEE OFF THE BOTTOM
	PIPE TEE OFF THE SIDE
	BLIND FLANGE
	END CAP
	PIPE BREAK
	FUEL OIL RETURN
	FUEL OIL SUPPLY

AIR SYSTEM LEGEND

	RECTANGULAR SUPPLY OUTSIDE AIR DUCT UP
	RECTANGULAR SUPPLY OUTSIDE AIR DUCT DOWN
	RECTANGULAR RETURN RELIEF AIR DUCT UP
	RECTANGULAR RETURN RELIEF AIR DUCT DOWN
	RECTANGULAR EXHAUST AIR DUCT UP
	RECTANGULAR EXHAUST AIR DUCT DOWN

TAGS AND CALL OUT SYMBOLS

	EQUIPMENT NUMBER		REVISION CALLOUT
	EQUIPMENT DESIGNATION		KEYNOTE CALLOUT
	SECTION CALLOUT		DETAIL CALLOUT
	SECTION DESIGNATION		DETAIL DESIGNATION
	SHEET NUMBER		SHEET NUMBER

FUEL OIL STORAGE TANK SCHEDULE

SYSTEM REFERENCE TAG	DESCRIPTION	LOCATION	MANUFACTURER	MODEL	DESIGN CAPACITY (L)	SIZE DIAMETER (mm)	SIZE LENGTH (mm)	OPERATING WEIGHT (KG)	REMARKS
FT-1E	DOUBLE WALL FUEL OIL TANK	ABOVEGROUND	HAASCO	HAS-26000 01-VAC	26000	2515	5512	23968	
NOTES:									
1. IAC CERTIFIED									
2. CNV VACUUM MONITORED INTERSPACE AND VACUUM SWITCH									
3. CNV FILL SPILL CONTAINER ON TOP OF TANK CNV LOCKABLE HINGED COVER									
4. PROVIDE OUTDOOR REMOTE FILL BOX W/ SPILL CONTAINER AND OUTDOOR TANK FILL MONITOR AND ALARM PANEL									

SHEET NUMBER	SHEET NAME	SCALE
M001E	MECHANICAL SYMBOLS, LEGENDS, DRAWING LIST & SITE PLAN - EARLY WORKS	NTS
M101E	FUEL TANK RELOCATION	1:100
M102E	AIR HANDLING UNIT RELOCATION	1:100
M103E	MECHANICAL DETAILS	NTS

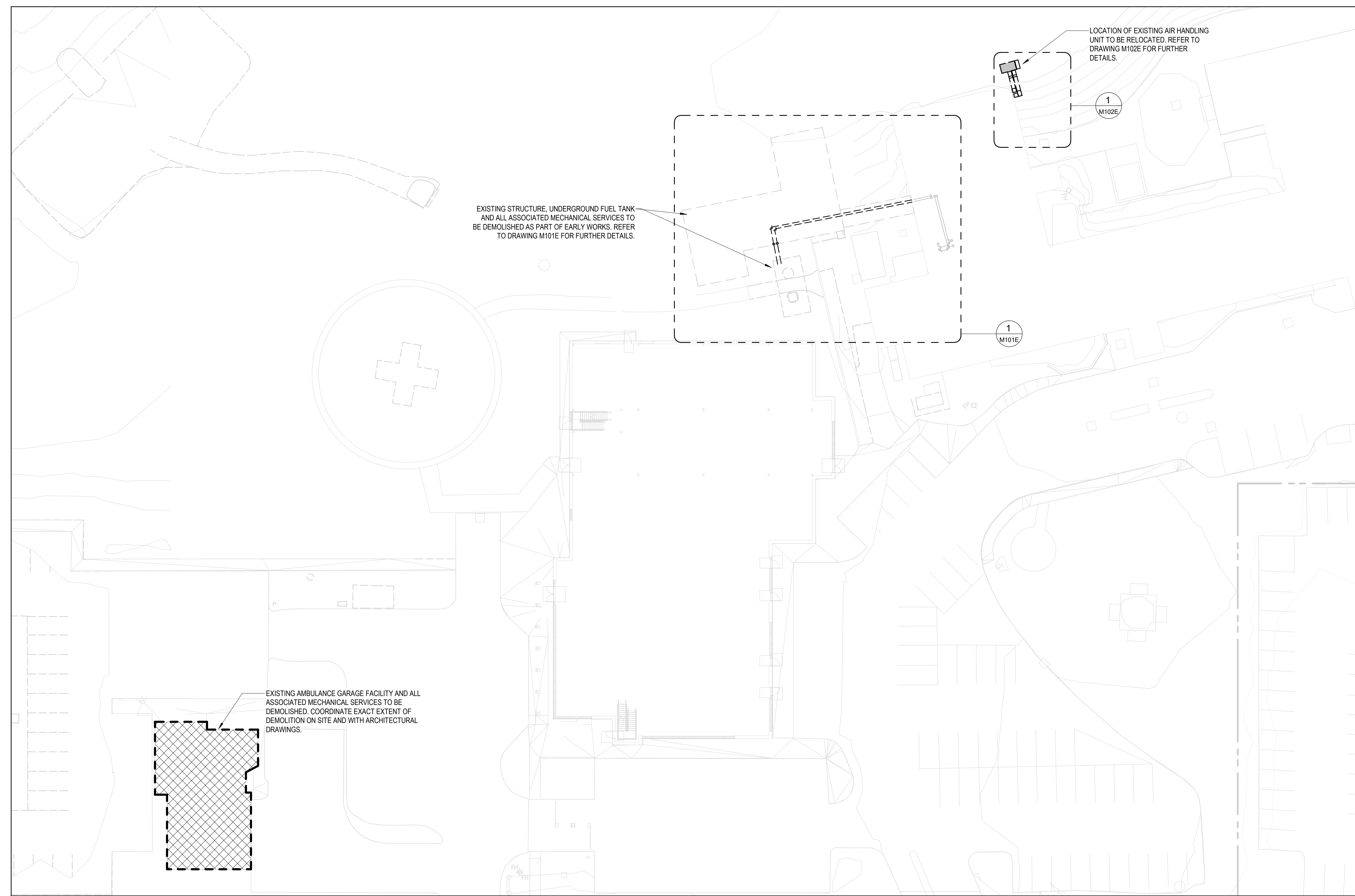

1 MECHANICAL SITE PLAN - EARLY WORKS - DEMOLITION WORK
M001E SCALE: 1:300

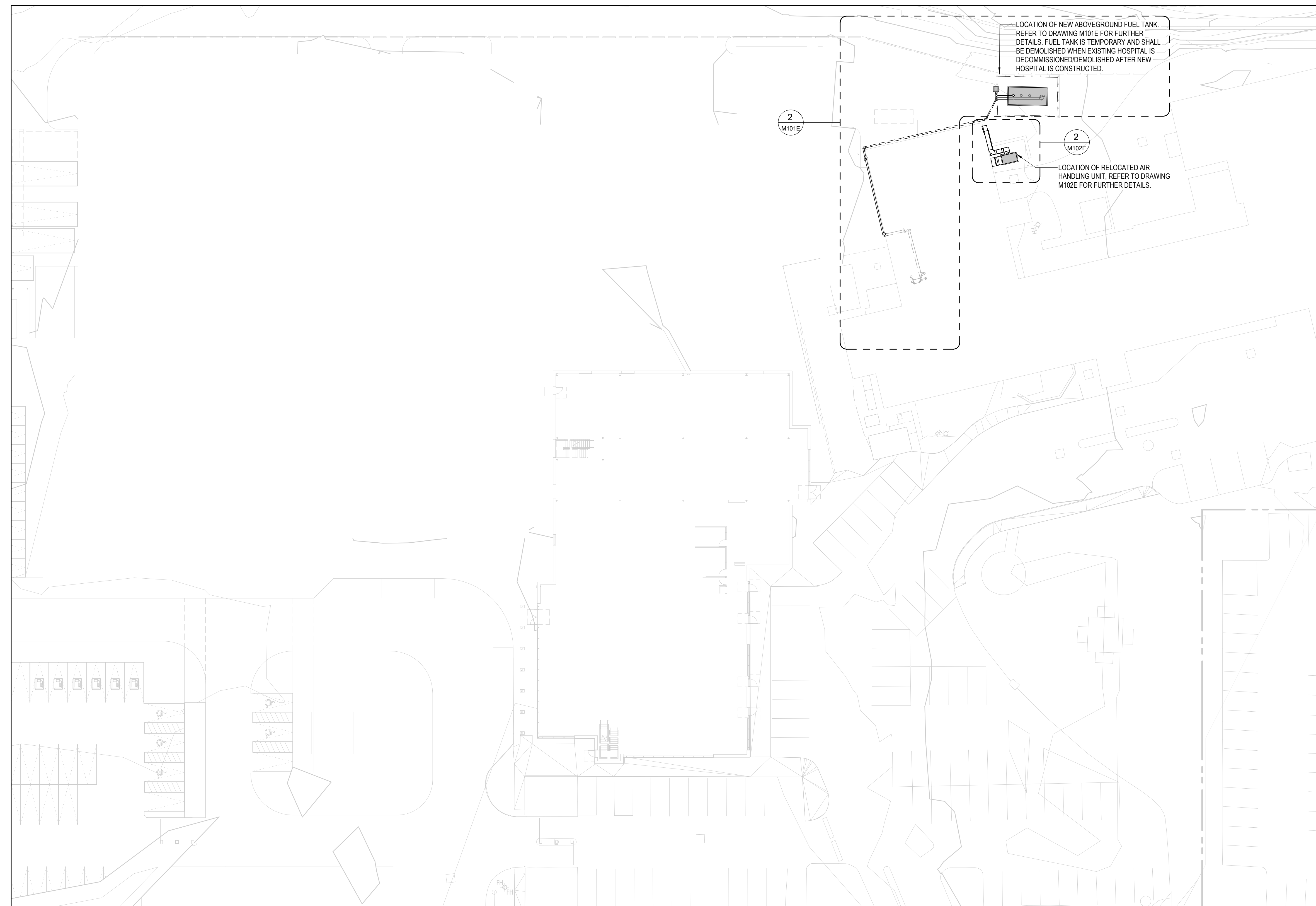

2 MECHANICAL SITE PLAN - EARLY WORKS - NEW WORK
M001E SCALE: 1:300

Issued

No.	Date	Description
1	2024-07-11	OWNER REVIEW
2	2024-11-28	ISSUED FOR SITE PLAN APPROVAL

exp Services Inc.
E: +1 905.666.3177
250 Commerce Valley Drive West
Suite 110, Markham, ON L3T 0A8
Canada

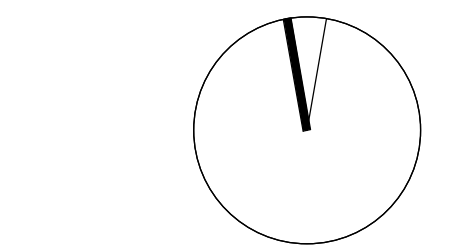

CLIENTS DO NOT SCALE DRAWINGS. THIS REPRODUCTION MAY BE AT A SIZE DIFFERENT THAN ORIGINALLY DRAWN. OUR ASSOCIATED RESPONSIBILITY FOR PROPORTION SCALING UNAUTHORIZED REPRODUCTION OR REUSE IS STRICTLY PROHIBITED. NOT RESPONSIBLE FOR ERRORS FROM UNAUTHORIZED USE OF THESE DRAWINGS AND NOTES. AUTHORIZATION MUST BE IN WRITING.



Oak Valley Health - Uxbridge Hospital

MECHANICAL SYMBOLS, LEGENDS, DRAWING LIST & SITE PLAN - EARLY WORKS
As Indicated

M001E

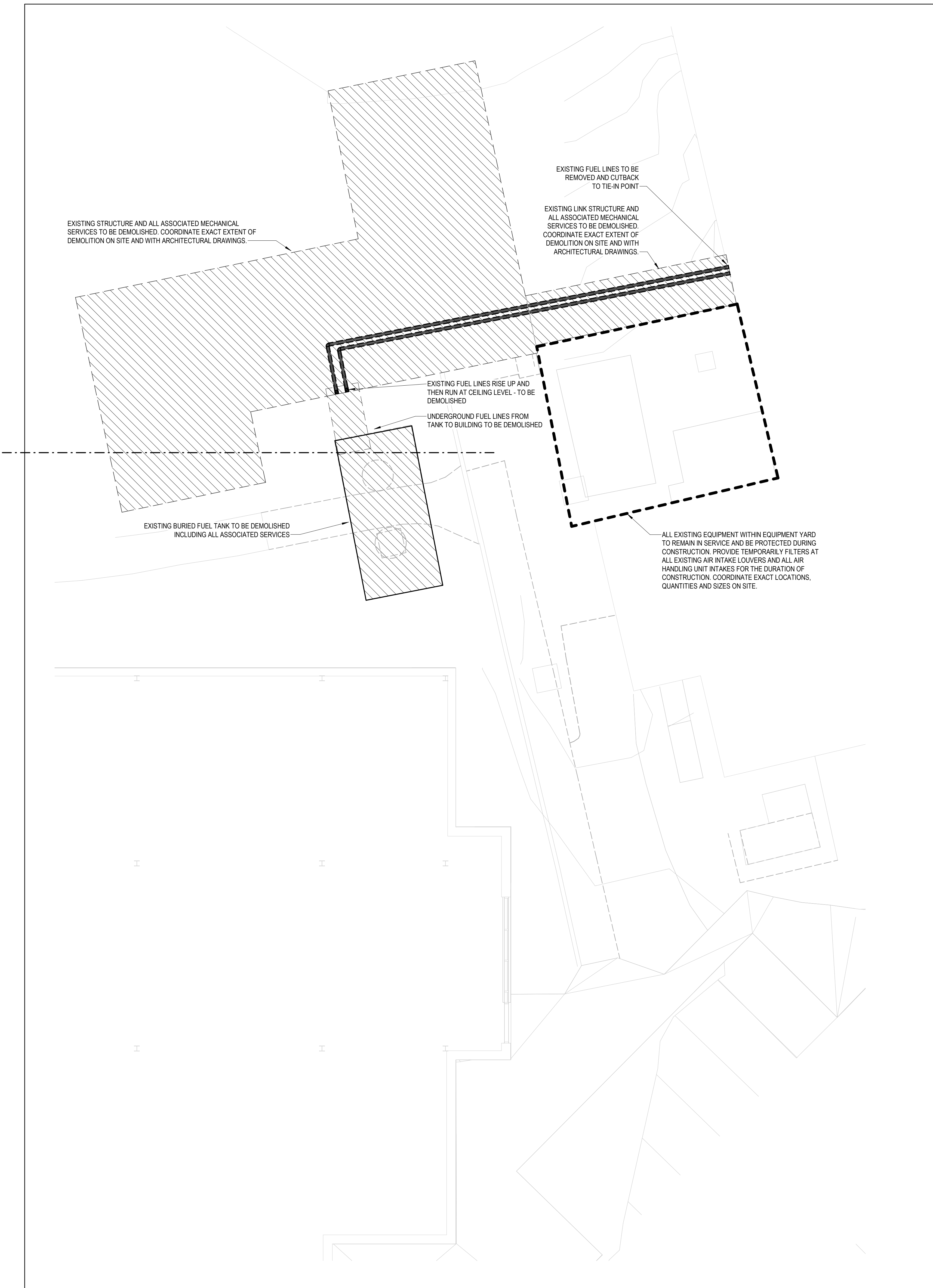

1 FUEL TANK RELOCATION - DEMOLITION WORK
M101E SCALE: 1:100

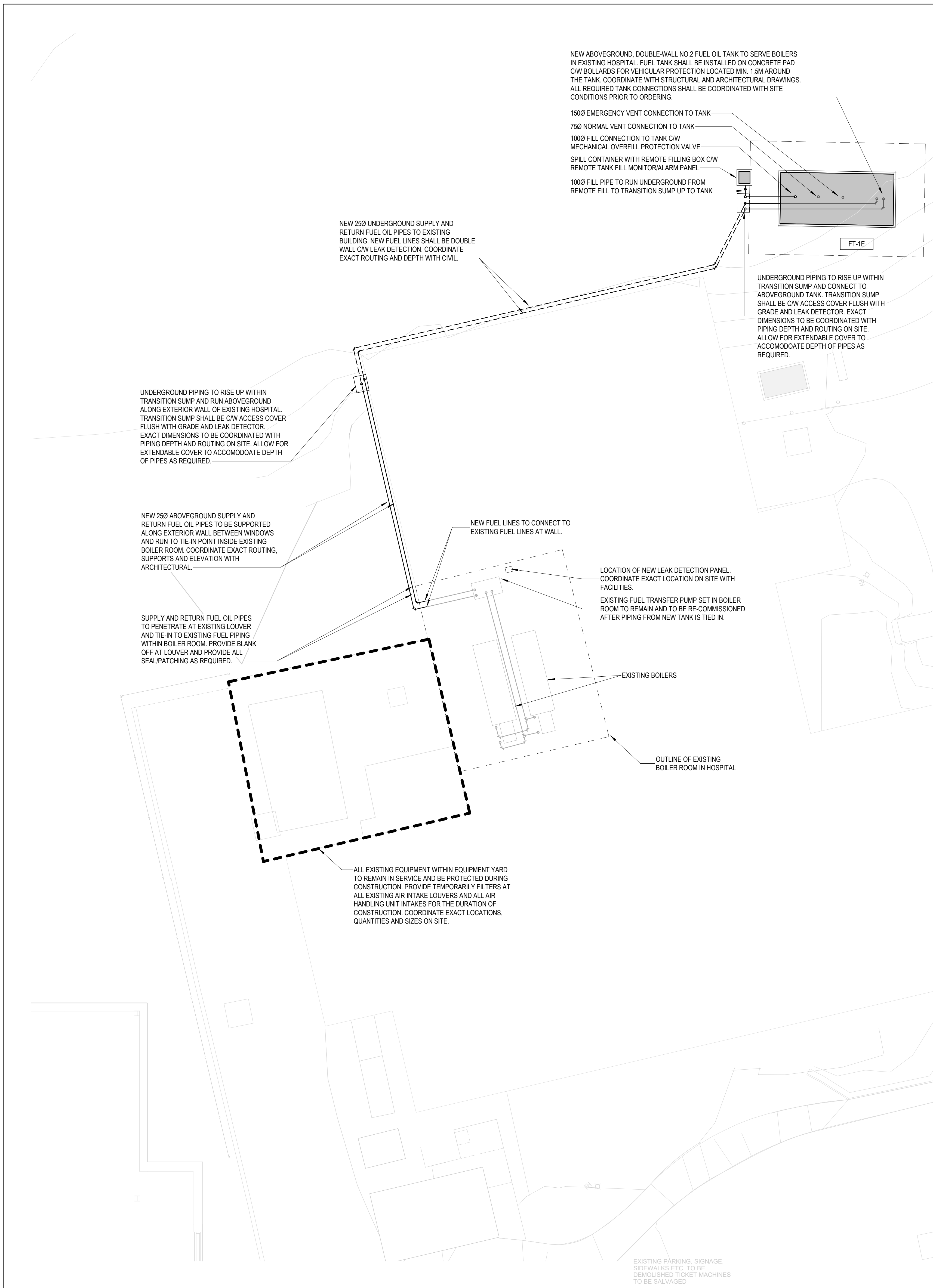

2 FUEL TANK RELOCATION - NEW WORK
M101E SCALE: 1:100

Issued	No.	Date	Description
1	2024-07-11	OWNER REVIEW	
2	2024-11-28	ISSUED FOR SITE PLAN APPROVAL	

- GENERAL NOTES:**
- ALL WORK SHALL BE DONE IN ACCORDANCE WITH THE REQUIREMENTS OF THE ONTARIO BUILDING CODE, MINISTRY OF THE ENVIRONMENT, MINISTRY OF LABOUR, THE MUNICIPALITY AND OTHER AUTHORITIES HAVING JURISDICTION WHICH ARE TO BE CONSIDERED AN INTEGRAL PART OF THE SPECIFICATION.
 - THE EXISTING SERVICES SHOWN ON THIS DRAWING HAVE BEEN TAKEN FROM THE ORIGINAL CONSTRUCTION DRAWINGS. THIS INFORMATION MUST NOT BE ASSUMED TO BE COMPLETE OR UP-TO-DATE. THE MECHANICAL SHALL CARRY OUT A FULL SURVEY OF ALL EXISTING SERVICES AND STRUCTURE TO CONFIRM THE SIZE AND LOCATION OF THESE SERVICES BEFORE THE COMMENCEMENT OF ANY WORK.
 - ALL EXISTING MECHANICAL SERVICES ARE SHOWN IN THEIR APPROXIMATE BEST ESTIMATED LOCATION. EXACT LOCATION OF THE SERVICES TO BE VERIFIED ON SITE BY CONTRACTOR PRIOR TO CONSTRUCTION.
 - ALL WORK MUST BE PERFORMED WITH MINIMAL DISRUPTION TO THE OPERATION OF THE HOSPITAL. COORDINATE WORK WITH THE HOSPITAL TO SCHEDULE WORK. CONTRACTOR TO ALLOW FOR AFTER-HOURS WORK AS REQUIRED BY THE HOSPITAL, TO BE COORDINATED WITH AND APPROVED BY THE HOSPITAL BEFORE THE START OF AFTER-HOURS WORK.
 - CONTRACTOR SHALL MAKE ALL ARRANGEMENTS FOR CUTTING, PATCHING, CORING, AND FIRESTOPPING, AS REQUIRED.
 - SUPPLY AND INSTALL STEEL PIPE SLEEVES FOR PIPES PASSING THROUGH FOUNDATION WALLS OR FLOORS. COORDINATE ALL SLEEVES AND OPENINGS TO AVOID CUTTING EXISTING REBAR, SCAN AREAS OF SLEEVES OR OPENINGS PRIOR TO CUTTING AND RELOCATE TO AVOID CUTTING EXISTING REINFORCEMENTS AND CONDUITS WHERE POSSIBLE.
 - COORDINATE COREDRILL LOCATIONS, SCANS AND SUBMIT COREDRILL REQUESTS FOR ENGINEERS REVIEW PRIOR TO PERFORMING THE WORK.
 - THE CONTRACTOR SHALL VISIT THE SITE AND FAMILIARIZE HIMSELF WITH LOCATION OF ALL EXISTING UTILITIES SUB-OUTS, PIPING, EQUIPMENT, ETC., AND/OR ANY CONDITION THAT MAY AFFECT HIS WORK. ALL THE NECESSARY RE-ROUTING, RELOCATING AND/OR REMOVAL OF EXISTING PIPING, EQUIPMENT, ETC., SHALL BE INCLUDED IN THE SCOPE OF WORK. IGNORANCE ON THE PART OF THE CONTRACTOR WILL IN NO WAY RELIEVE HIM OF THE OBLIGATIONS AND RESPONSIBILITIES ASSUMED UNDER THIS CONTRACT.
 - CONTRACTOR SHALL TAKE ALL NECESSARY PRECAUTIONS TO PROTECT PROPERTY IN AREAS WHERE WORK IS BEING CONDUCTED. THE CONTRACTOR IS RESPONSIBLE FOR ANY DAMAGES CAUSED TO BUILDING COMPONENTS DUE TO WORK OPERATIONS PATCH AND REPAIR EXISTING SURFACES DAMAGED AS REQUIRED TO MATCH ADJACENT SURFACES.
 - EXISTING PIPES SERVING AREAS REMAINING IN SERVICE AT THIS TIME SHALL NOT BE INTERRUPTED UNLESS A TEMPORARY INTERRUPTION IS COORDINATED WITH THE OWNER.
 - CONTRACTOR TO VERIFY AND CLEAR ALL EXISTING SERVICES WHEN INSTALLING NEW PIPING. CLEARANCES TO BE VERIFIED ON SITE PRIOR TO ANY WORK.
 - CHECK AND VERIFY LOCATIONS OF ALL PIPES WITH ALL OTHER TRADES TO PREVENT INTERFERENCE.
 - PROVIDE ACCESS DOOR FOR ALL VALVES AND CLEANOUTS LOCATED ABOVE DRY WALL CEILING.
 - CONTRACTOR TO RUN ALL PIPING DISTRIBUTION AS TIGHT AS POSSIBLE TO THE UNDERSIDE OF SLAB STRUCTURE.
 - ALL EXISTING SERVICES AND UTILITIES ARE TO BE MAINTAINED AND COORDINATED WITH BY THE CONTRACTOR. ANY DISRUPTION MUST BE COORDINATED WITH THE FACILITY PRIOR TO THE WORK.
 - COORDINATE LOCATION OF NEW PIPING WITH EXISTING. IF THERE IS A REQUIREMENT OF ANY RELOCATION OF EXISTING SERVICES, CONTRACTOR MUST REPORT BACK TO THE ENGINEER AND FACILITY PRIOR TO THE WORK. SERVICES MUST BE TESTED AFTER THE WORK IS COMPLETE.
 - CONTRACTOR SHALL PATCH, REPAIR, FILL ETC. ALL WALLS AND FLOORS AFFECTED BY THE EXTENT OF WORK.
 - PROTECT ALL FIRE ALARM AND LIFE SAFETY SYSTEMS DURING CONSTRUCTION.
 - PROTECT ALL EXISTING EQUIPMENT AND SERVICES FROM DEBRIS AND UNWANTED MATERIALS. CLEAN AS NECESSARY TO MAINTAIN SERVICE DURING DEMOLITION PERIOD AND ON COMPLETION OF THE WORK.
 - CONTRACTOR SHALL BE RESPONSIBLE FOR COORDINATING AND SCHEDULING FOR ANY REQUIRED SHUT-DOWN WITH HOSPITAL. CONTRACTOR SHALL INCLUDE FOR AND DETERMINE THE BEST METHOD TO MINIMIZE SERVICE INTERRUPTION AND IMPACT ON HOSPITAL OPERATION, INCLUDING USE OF HOT TAP/TEMPORARY FREEZING AND AFTER-HOURS WORK AS REQUIRED.
 - CONTRACTOR SHALL PROVIDE FIRE-STOPPING ON ALL NEW PIPING AND CONDUIT PENETRATIONS THROUGH A FIRE-RATED WALL OR FLOOR AND ANY HOLES THAT RESULT FROM REMOVAL OF EXISTING SERVICES THROUGH A FIRE-RATED WALL OR FLOOR. FIRE STOPPING SHALL BE IN ACCORDANCE WITH THE SPECIFICATIONS.
 - CONTRACTOR TO ALLOW FOR INDIVIDUAL HOARDING ZONES FOR EACH SERVICE AREA OF SCOPE. INCLUDE FOR AFTER HOURS WORK. COORDINATE EXTENT OF HOARDING AND CONSTRUCTION SCHEDULE WITH ARCHITECT AND THE FACILITY PRIOR TO COMMENCEMENT TO WORK.

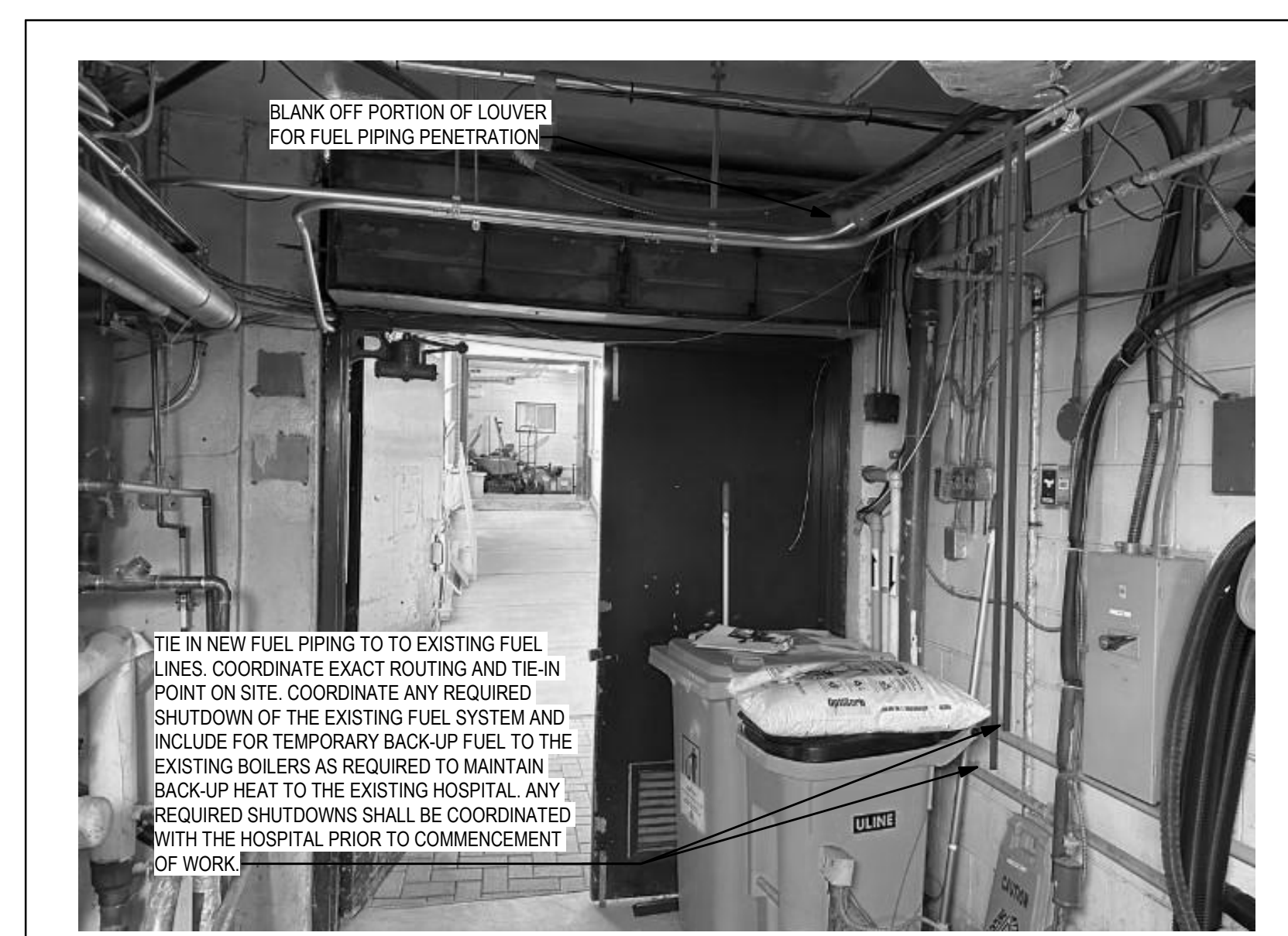

3 PHOTO OF EXISTING FUEL LINES
M101E SCALE: 1:5

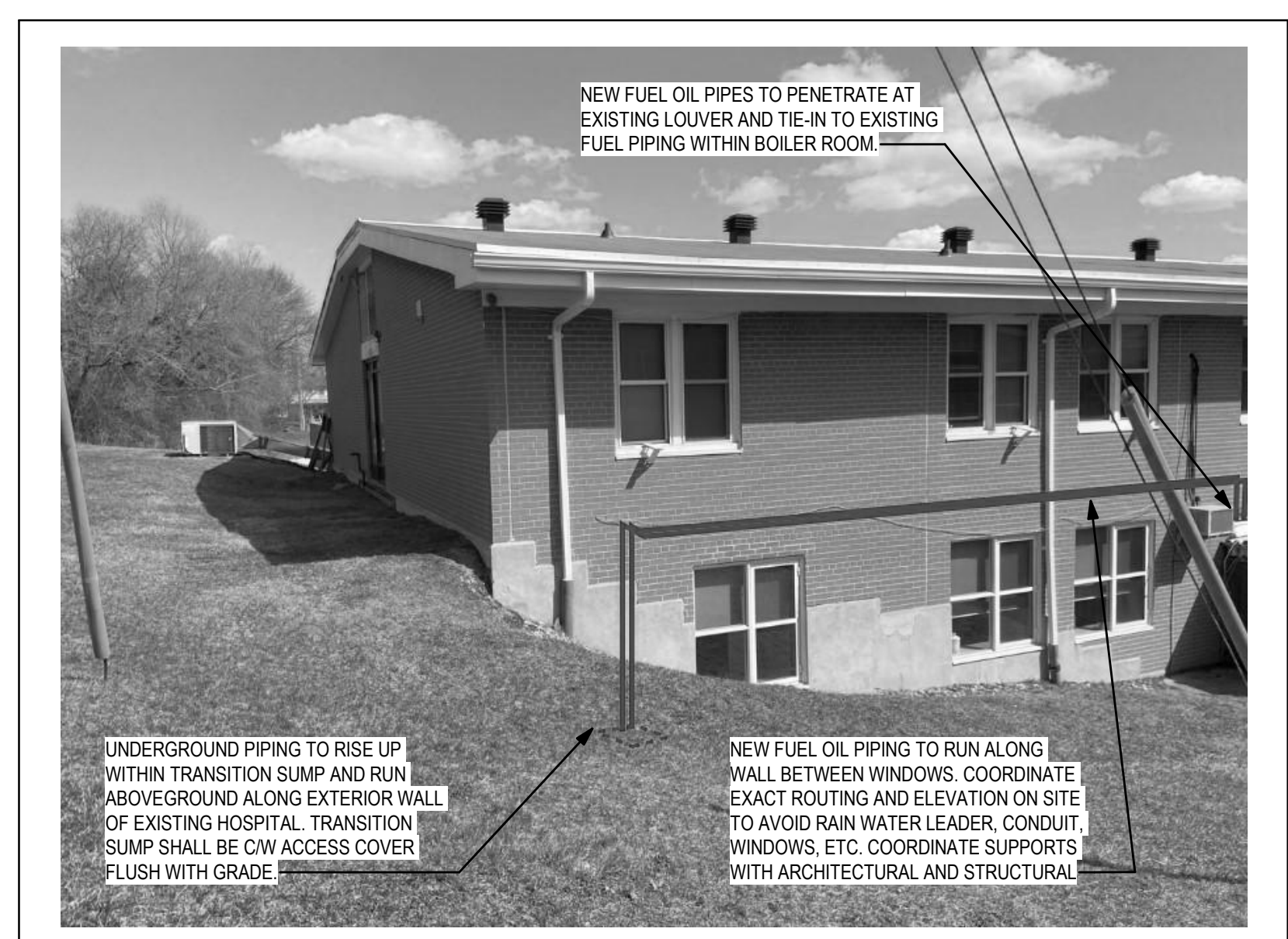

4 PHOTO OF EXTERIOR FUEL PIPING
M101E SCALE: 1:5

A:\Projects\Draws\2024\10102_M101E_Hospital\10102_02_M101E_Mech_CDPS_R1.dwg, 1/17/2024 10:08:09 AM



1 AIR HANDLING UNIT RELOCATION - DEMOLITION WORK
M102E SCALE: 1:100

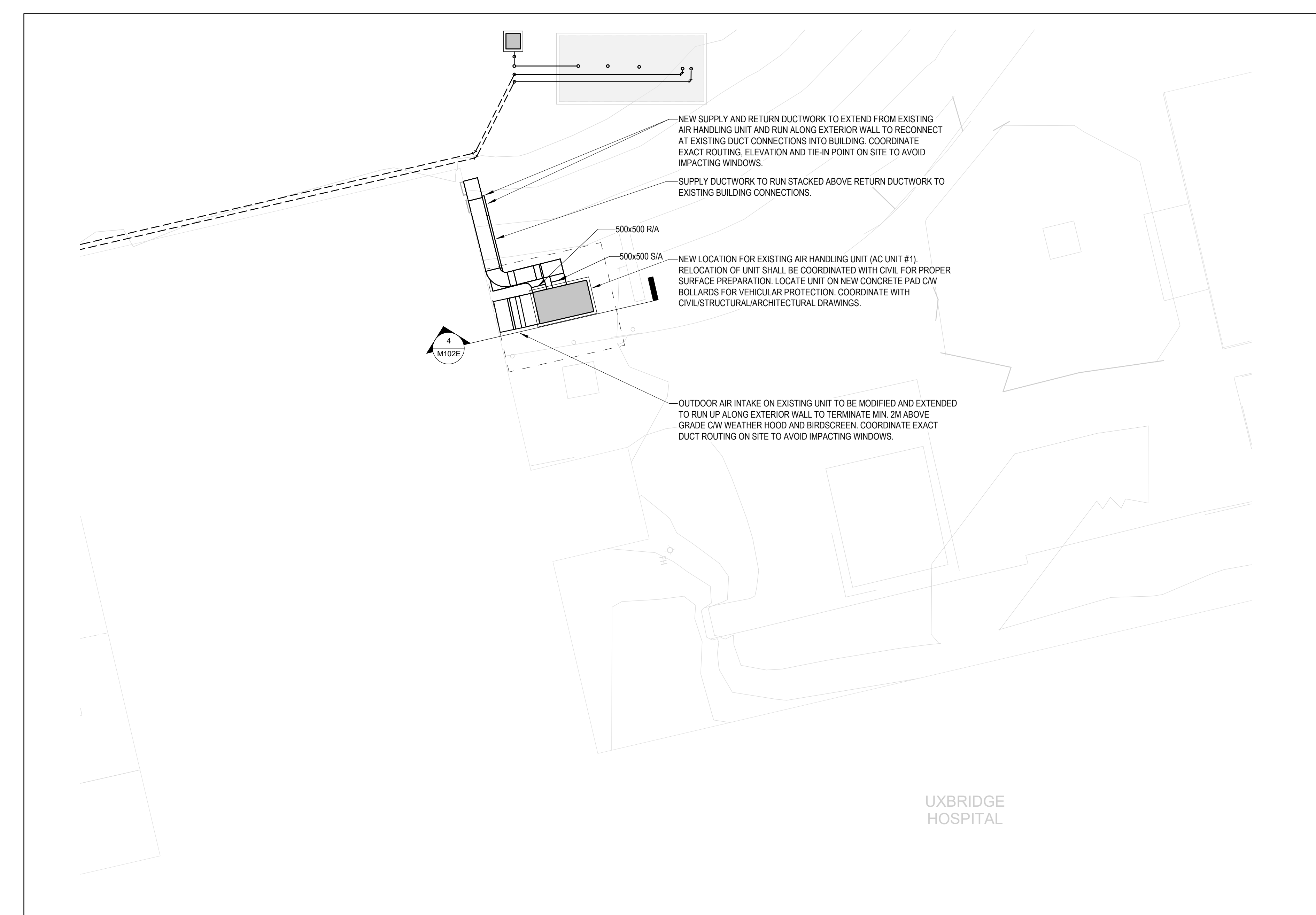

2 AIR HANDLING UNIT RELOCATION - NEW WORK
M102E SCALE: 1:100

- GENERAL NOTES:**
- ALL WORK SHALL BE DONE IN ACCORDANCE WITH THE REQUIREMENTS OF THE ONTARIO BUILDING CODE, MINISTRY OF THE ENVIRONMENT, MINISTRY OF LABOUR, THE MUNICIPALITY AND OTHER AUTHORITIES HAVING JURISDICTION WHICH ARE TO BE CONSIDERED AN INTEGRAL PART OF THE SPECIFICATION.
 - THE EXISTING SERVICES SHOWN ON THIS DRAWING HAVE BEEN TAKEN FROM THE ORIGINAL CONSTRUCTION DRAWINGS. THIS INFORMATION MUST NOT BE ASSUMED TO BE COMPLETE OR UP-TO-DATE. THE MECHANICAL SHALL CARRY OUT A FULL SURVEY OF ALL EXISTING SERVICES AND STRUCTURE TO CONFIRM THE SIZE AND LOCATION OF THESE SERVICES BEFORE THE COMMENCEMENT OF ANY WORK.
 - ALL EXISTING MECHANICAL SERVICES ARE SHOWN IN THEIR APPROXIMATE BEST ESTIMATED LOCATION. EXACT LOCATION OF THE SERVICES TO BE VERIFIED ON SITE BY CONTRACTOR PRIOR TO CONSTRUCTION.
 - ALL WORK MUST BE PERFORMED WITH MINIMAL DISRUPTION TO THE OPERATION OF THE HOSPITAL. COORDINATE WORK WITH THE HOSPITAL TO SCHEDULE WORK. CONTRACTOR TO ALLOW FOR AFTER-HOURS WORK AS REQUIRED BY THE HOSPITAL, TO BE COORDINATED WITH AND APPROVED BY THE HOSPITAL BEFORE THE START OF AFTER-HOURS WORK.
 - CONTRACTOR SHALL MAKE ALL ARRANGEMENTS FOR CUTTING, PATCHING, CORING, AND FIRESTOPPING, AS REQUIRED.
 - SUPPLY AND INSTALL STEEL PIPE SLEEVES FOR PIPES PASSING THROUGH FOUNDATION WALLS OR FLOORS. COORDINATE ALL SLEEVES AND OPENINGS TO AVOID CUTTING EXISTING REBAR. SCAN AREAS OF SLEEVES OR OPENINGS PRIOR TO CUTTING AND RELOCATE TO AVOID CUTTING EXISTING REINFORCEMENTS AND CONDUITS WHERE POSSIBLE.
 - COORDINATE COREDRILL LOCATIONS, SCANS AND SUBMIT COREDRILL REQUESTS FOR ENGINEERS REVIEW PRIOR TO PERFORMING THE WORK.
 - THE CONTRACTOR SHALL VISIT THE SITE AND FAMILIARIZE HIMSELF WITH LOCATION OF ALL EXISTING UTILITIES STUB-OUTS, PIPING, EQUIPMENT, ETC. AND/OR ANY CONDITION THAT MAY AFFECT HIS WORK. ALL THE NECESSARY RE-ROUTING, RELOCATING AND/OR REMOVAL OF EXISTING PIPING, EQUIPMENT, ETC. SHALL BE INCLUDED IN THE SCOPE OF WORK. IGNORANCE ON THE PART OF THE CONTRACTOR WILL IN NO WAY RELIEVE HIM OF THE OBLIGATIONS AND RESPONSIBILITIES ASSUMED UNDER THIS CONTRACT.
 - CONTRACTOR SHALL TAKE ALL NECESSARY PRECAUTIONS TO PROTECT PROPERTY IN AREAS WHERE WORK IS BEING CONDUCTED. THE CONTRACTOR IS RESPONSIBLE FOR ANY DAMAGES CAUSED TO BUILDING COMPONENTS DUE TO WORK OPERATIONS PATCH AND REPAIR EXISTING SURFACES DAMAGED AS REQUIRED TO MATCH ADJACENT SURFACES.
 - EXISTING PIPES SERVING AREAS REMAINING IN SERVICE AT THIS TIME SHALL NOT BE INTERRUPTED UNLESS A TEMPORARY INTERRUPTION IS COORDINATED WITH THE OWNER.
 - CONTRACTOR TO VERIFY AND CLEAR ALL EXISTING SERVICES WHEN INSTALLING NEW PIPING. CLEARANCES TO BE VERIFIED ON SITE PRIOR TO ANY WORK.
 - CHECK AND VERIFY LOCATIONS OF ALL PIPES WITH ALL OTHER TRADES TO PREVENT INTERFERENCE.
 - PROVIDE ACCESS DOOR FOR ALL VALVES AND CLEANOUTS LOCATED ABOVE DRY WALL CEILING.
 - CONTRACTOR TO RUN ALL PIPING DISTRIBUTION AS TIGHT AS POSSIBLE TO THE UNDERSIDE OF SLAB STRUCTURE.
 - ALL EXISTING SERVICES AND UTILITIES ARE TO BE MAINTAINED AND COORDINATED WITH BY THE CONTRACTOR. ANY DISRUPTION MUST BE COORDINATED WITH THE FACILITY PRIOR TO THE WORK.
 - COORDINATE LOCATION OF NEW PIPING WITH EXISTING. IF THERE IS A REQUIREMENT OF ANY RELOCATION OF EXISTING SERVICES. CONTRACTOR MUST REPORT BACK TO THE ENGINEER AND FACILITY PRIOR TO THE WORK. SERVICES MUST BE TESTED AFTER THE WORK IS COMPLETE.
 - CONTRACTOR SHALL PATCH, REPAIR, FILL ETC. ALL WALLS AND FLOORS AFFECTED BY THE EXTENT OF WORK.
 - PROTECT ALL FIRE ALARM AND LIFE SAFETY SYSTEMS DURING CONSTRUCTION.
 - PROTECT ALL EXISTING EQUIPMENT AND SERVICES FROM DEBRIS AND UNWANTED MATERIALS. CLEAN AS NECESSARY TO MAINTAIN SERVICE DURING DEMOLITION PERIOD AND ON COMPLETION OF THE WORK.
 - CONTRACTOR SHALL BE RESPONSIBLE FOR COORDINATING AND SCHEDULING FOR ANY REQUIRED SHUT-DOWN WITH HOSPITAL. CONTRACTOR SHALL INCLUDE FOR AND DETERMINE THE BEST METHOD TO MINIMIZE SERVICE INTERRUPTION AND IMPACT ON HOSPITAL OPERATION, INCLUDING USE OF HOT TAP/TEMPORARY FREEZING AND AFTER-HOURS WORK AS REQUIRED.
 - CONTRACTOR SHALL PROVIDE FIRE-STOPPING ON ALL NEW PIPING AND CONDUIT PENETRATIONS THROUGH A FIRE-RATED WALL OR FLOOR AND ANY HOLES THAT RESULT FROM REMOVAL OF EXISTING SERVICES THROUGH A FIRE-RATED WALL OR FLOOR. FIRE STOPPING SHALL BE IN ACCORDANCE WITH THE SPECIFICATIONS.
 - CONTRACTOR TO ALLOW FOR INDIVIDUAL HOARDING ZONES FOR EACH SERVICE AREA OF SCOPE. INCLUDE FOR AFTER HOURS WORK. COORDINATE EXTENT OF HOARDING AND CONSTRUCTION SCHEDULE WITH ARCHITECT AND THE FACILITY PRIOR TO COMMENCEMENT TO WORK.

Issued

No.	Date	Description
1	2024-07-11	OWNER REVIEW
2	2024-11-28	ISSUED FOR SITE PLAN APPROVAL



3 PHOTO OF EXISTING AIR HANDLING UNIT
M102E SCALE: 1:1

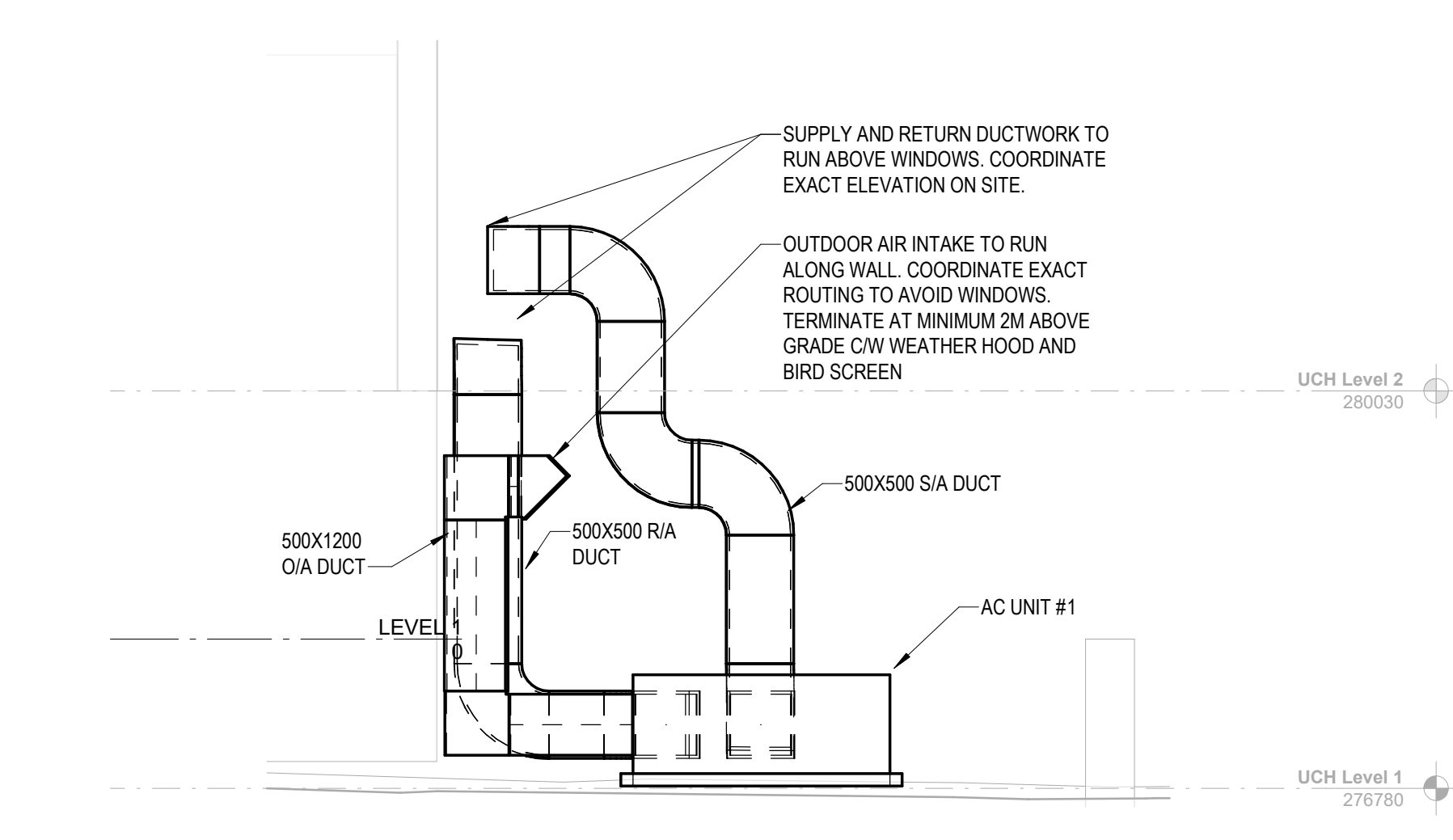

4 ELEVATION SECTION - AC UNIT #1
M102E SCALE: 1:50

exp Services Inc.
E: +1 905.666.3377
220 Commerce Valley Drive West
Suite 110, Markham, ON L3T 0A8
Canada
www.exp.com



OWNER: DO NOT SCALE DRAWINGS
THIS REPRODUCTION MAY BE AT A SIZE DIFFERENT THAN ORIGINALLY DRAWN. EXP ASSUMES NO RESPONSIBILITY FOR REPRODUCTION SCALING. UNAUTHORIZED REPRODUCTION OR REUSE IS STRICTLY PROHIBITED. NOT RESPONSIBLE FOR ERRORS FROM UNAUTHORIZED USE OF THESE DRAWINGS AND NOTES. AUTHORIZATION MUST BE IN WRITING.
© exp 2024



11/27/2024 4:06:48 PM Autodesk Docs: 2271202:Uxbridge Hospital-M102E-MECH-CIP-Building-RCA.rvt

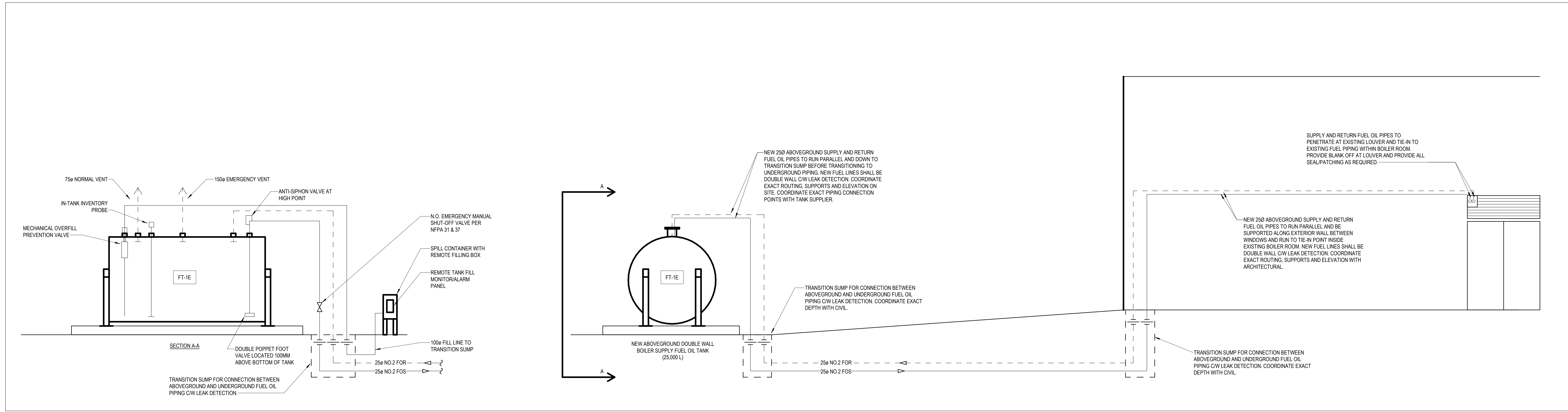

No.	Date	Description
1	2024-07-11	OWNER REVIEW
2	2024-11-28	ISSUED FOR SITE PLAN APPROVAL

01 EARLY WORKS - FUEL TANK RELOCATION ELEVATION SKETCH - NEW WORK
M103E/ N.T.S.

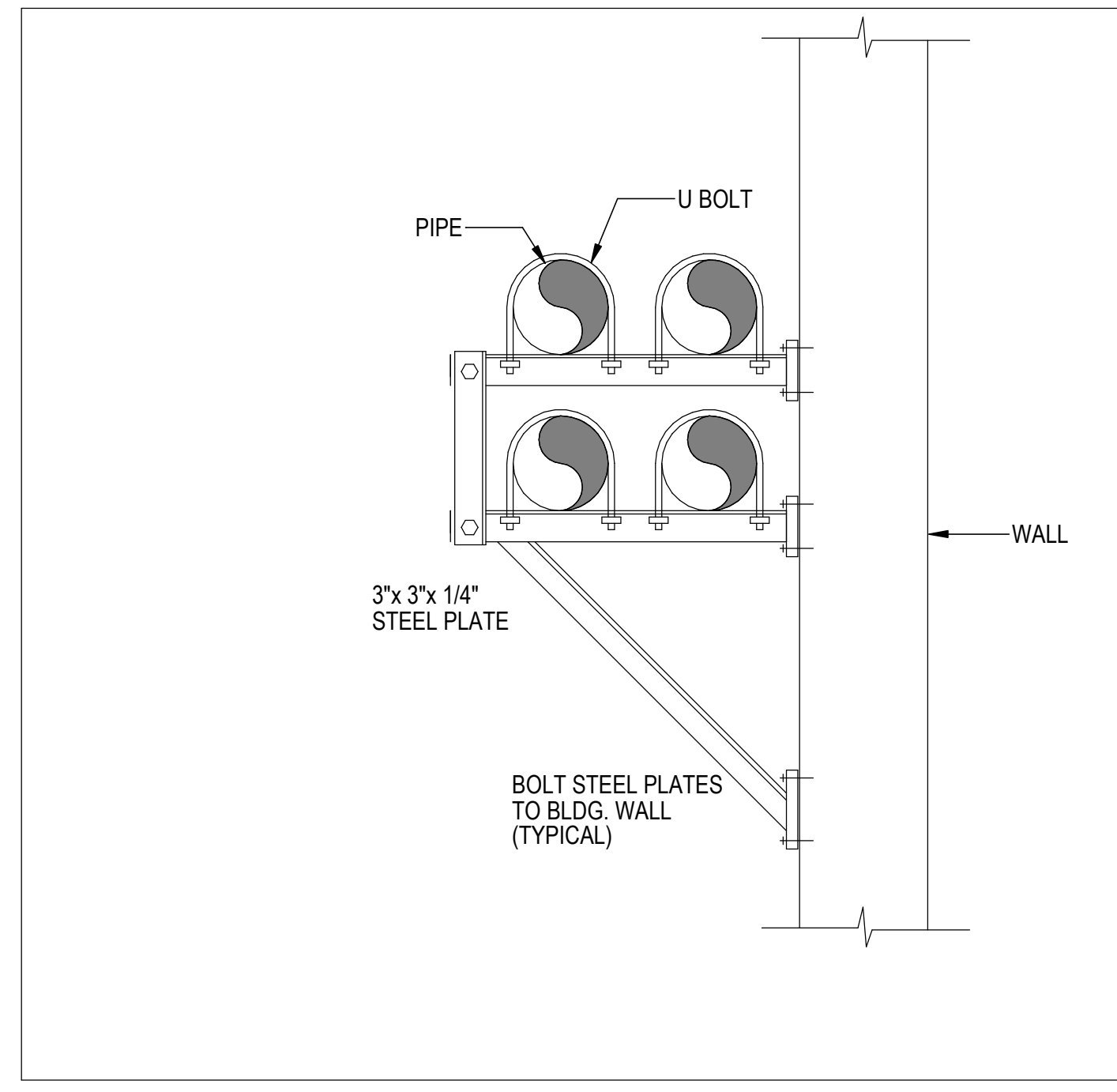

02 EXTERIOR PIPE RACK SUPPORT DETAIL
M103E/ N.T.S.

exp Services Inc.
E: +1 905.666.3177
220 Commerce Valley Drive West
Suite 110, Markham, ON L3T 0A8
Canada
www.exp.com



CLIENTS DO NOT SCALE DRAWINGS. THIS REPRODUCTION MAY BE AT A SIZE DIFFERENT THAN ORIGINALLY DRAWN. EXP ASSUMES NO RESPONSIBILITY FOR REPRODUCTION. UNAUTHORIZED REPRODUCTION OR REUSE IS STRICTLY PROHIBITED. NOT RESPONSIBLE FOR ERRORS FROM UNAUTHORIZED USE OF THESE DRAWINGS AND NOTES. AUTHORIZATION MUST BE IN WRITING.

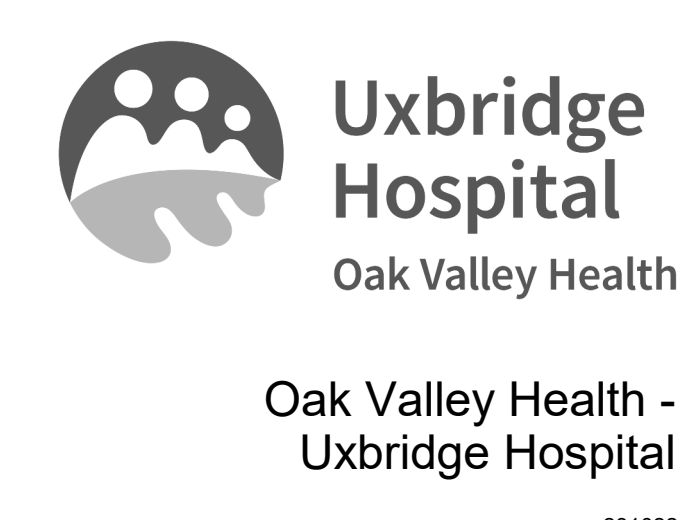

1:1072024 E:06/25/PM