

NO.	CHAINAGE	FINAL GRATE ELEV.	INVERT ELEV.		LENG. (FT)	GRADE (%)	RAIL
			IN	OUT			
CB15-3	16+95.6	876.62	—	871.39	26.3		
CB15-4	16+90	876.62	—	871.29	10.6		

NO.	CHAINAGE	E/P ELEV.	LENG. (FEET)	GRADE (%)	RAIL
2	15+08.6	880.03			
3	14+99.2	880.15	29.00	2.22	2.0
4	17+28.2	879.45			

MAIN ST. REG. RD. I

- NOTES:
1. PLACE 10' OF 6" C.S.P. PERF. UPHILL OF EACH CB. DR. CBMH.
 2. FOR PROP. SAN. SEW. CONSTRUCTION REFER TO: DWG. NO. U-84-S-84.
 3. FOR PROP. WM. CONSTRUCTION REFER TO: DWG. NO. U-84-W-89.

NO.	CHAINAGE	LEN.	QTY.	DESCRIPTION
G11	14+85	33'		CONC. C & G
G2	14+85	25'		CONC. C & G
T1	15+20	1		2' STUMP
T4	15+40	2		2.5' STUMPS
T3	15+74	1		2' STUMP
S1	16+00	23'		4' CONC. SW
S2	16+00	20'		3.5' 10' A G SW
C1	15+57	2'		12' C.S.P.
C2	15+97	2'		14' C.S.P.
C3	16+77	4'		15' C.S.P.
C4	16+85	2'		12' C.S.P.
B1	16+93	1		2' x 4' GB
M1	15+85	1		CONC. HEADWALL

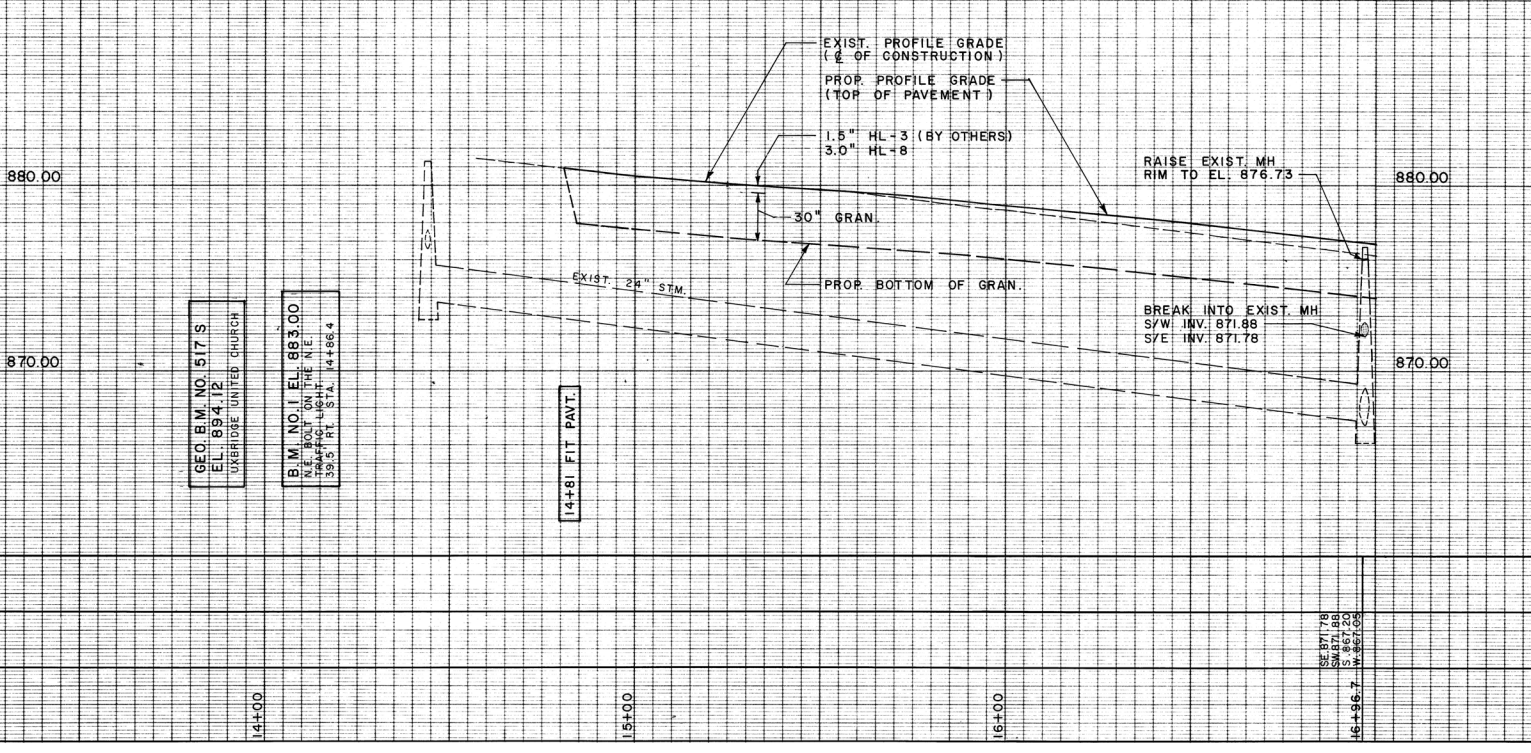

LENGTH, SIZES AND GRADES
STORM SEWER INVERT EL.
OF CONSTRUCTION CHAINAGE

RESPONSIBLE FOR LOCATION OF G & OVERHEAD UTILITIES. VARIOUS TO BE GIVEN REQUIRED ADVANCE ANY DIGGING, FOR STAKE OUT THE CONSUMERS GAS RESPONSIBILITY FOR THE ACCURACY OF EXISTING UTILITIES AS INDICATED

UTILITY VERIFICATION

BELL CANADA	—	1984 08 10
CABLE T.V.	—	
CONSUMERS GAS	—	1984 07 26
ONTARIO HYDRO	—	1984 08 01
P. U. C.	—	1984 07 31



1986 02	Am. F	AS CONSTRUCTED
85 06 4	D.L.	RELOCATED B.P. STA. 16+98
NO.	DATE	NAME
		REVISIONS

DRAWN: T. CLARKE, D. LINKLATER DATE: 1984 10 22
 DESIGN: D. LINKLATER DATE: 1984 11 22
 CHECKED: M. WILSON DATE: 1985 01 08
 APPROVED: K. SCHIPPER DATE: 1985 01 08

SCALE: HORIZ. 1" = 20'
 VERT. 1" = 4'

FIELD BOOK NO. _____
 UPDATE: 1983 01 27

THE REGIONAL MUNICIPALITY OF DURHAM
 DEPARTMENT OF WORKS
 WHITBY ONTARIO

REGIONAL ROAD I, MAIN ST.
 FROM BROCK ST. TO 240' NORTH.

RD. NO. _____ LOT NO. _____ CON. _____ TWP. _____ AREA (UXBRIDGE)